

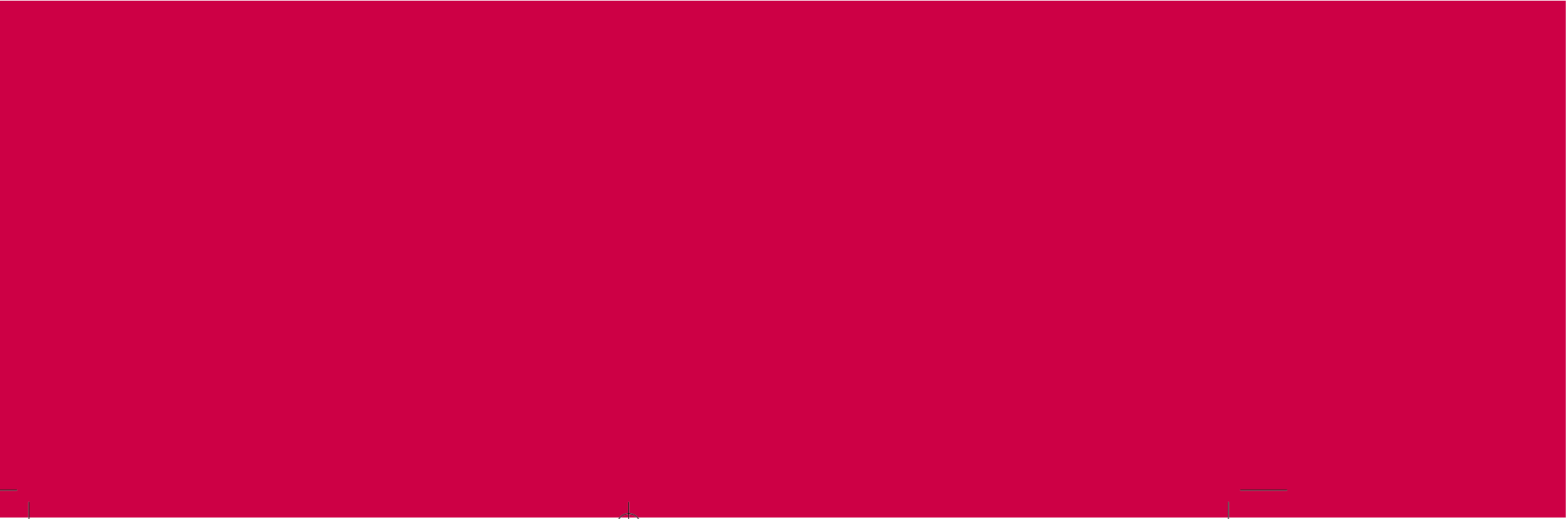

LG Electronics Inc.

P/No. : 3828ED3001L





DISHWASHER

SERVICE MANUAL

NOTE

BEFORE SERVICING THE UNIT, PLEASE READ THIS MANUAL CAREFULLY
FOR SAFETY AND CORRECT SERVICES.

MODEL : LD-4050W
LD-14AW2, LD-14AT 2



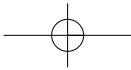

CONTENTS

1. CAUTION	4
2. SPECIFICATIONS	5
3. FEATURES & TECHNICAL EXPLANATION	6
4. PARTS NAME	11
5. WIRING DIAGRAM	13
6. PROGRAM CHART (SCHEMATIC DIAGRAM)	15
7. HOW TO DISASSEMBLE	17
8. TROUBLE SHOOTING METHODS	27
A. TROUBLE SHOOTING ACCORDING TO DISPLAYED ERROR MESSAGE	27
B. TROUBLE DIAGNOSES AND REPAIR BY SYMPTOM	29
9. INSTALLATION INSTRUCTION	33
10. EXPLODED VIEW	38
11. REPLACEMENT PART LIST	44

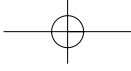

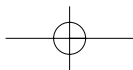

CAUTION !

- DISCONNECT POWER CORD BEFORE SERVING
- RECONNECT ALL GROUNDING DEVICES

IMPORTANT SAFETY NOTICE !

This service information is intended for individuals possessing adequate backgrounds of electrical, electronic and mechanical experience.

Any attempt to repair this appliance may result in personal injury and property damage.

The manufacturer or seller can not be responsible for the interpretation of this information, nor can it assume any liability in connection with its use.

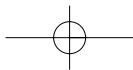

2. SPECIFICATION

ITEM	SPECIFICATION		
Model	LD-4050W	LD-14AT2	LD-14AW2
Rated Voltage / Frequency	AC 240V/50Hz	AC 240V/50Hz	AC 240V/50Hz
Installation	Free Standing / built-In	Free Standing / built-In	Free Standing / built-In
Place Settings	14	14	14
Product Dimension(mm)	600(W) × 600(D) × 850(H)	600(W) × 600(D) × 850(H)	600(W) × 600(D) × 850(H)
Product Weight(Kg)	52	52	52
Door Colour	White	Stainless Steel	White
Tub Material	Stainless Steel	Stainless Steel	Stainless Steel
Control	Electronic(Fussy)	Electronic	Electronic
Rated Power(Watt)	2,210	2,210	2,210
Heater Power(Watt)	2,100	2,100	2,100
Programs	6	6	6
Upper Rack Position	Sliding Adjustable	Sliding Adjustable	Adjustable
Lower Rack	100% Fold down	100% Fold down	50% Fold down
Water Consumption(ℓ)	18 (Economy)	18 (Economy)	18 (Economy)
Power Consumption (kWh)	0.7 (Economy)	0.7 (Economy)	0.7 (Economy)
Operating Time (min)	84 (Economy)	84 (Economy)	84 (Economy)
Fan Dry System	Yes	Yes	Yes
Delay Start Function	Yes	Yes	Yes
Auto-Off Power Switch	Yes	Yes	Yes
Process Monitor	Yes	Yes	Yes
Wash Level	5	5	5
Racks	Nylon Coating	Nylon Coating	Nylon Coating
Operating Water Pressure (Bar)	0.5 ~ 8	0.5 ~ 8	0.5 ~ 8

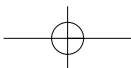

3. FEATURES & TECHNICAL EXPLANATION

3-1 New Technology Introduction

3-1-1. Turbo Fan Drying System

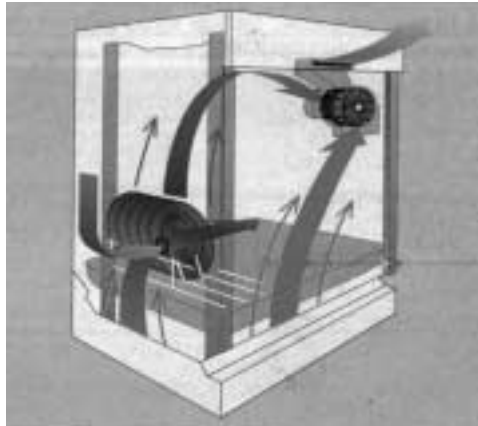

- Turbo fan drying system expels out hot and humid air to enhance quick and effective drying.

3-1-2. High Temperature Rinsing

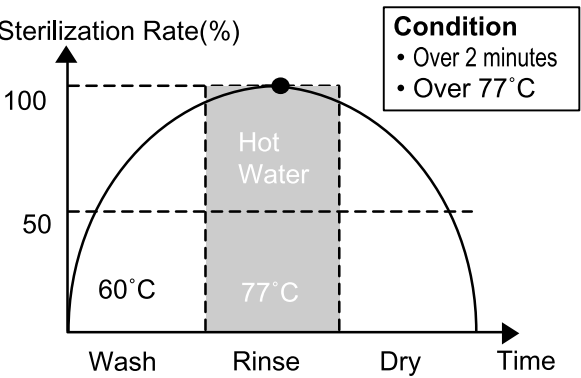

- During the high temp. Rinse course, water temperature in an dishwasher reaches 77°C, considerably higher than the average rinse temperature in conventional dishwashers(65°C). This is how Rinse 77°C can eliminate some bacteria such as salmonella.

3-1-3. Turbo Spray System

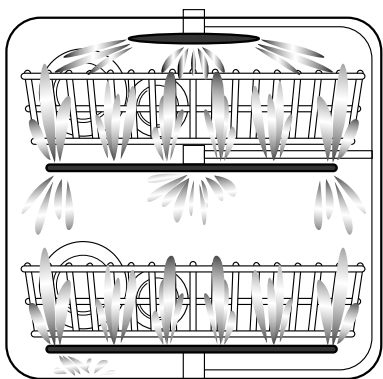

- Turbo Spray System is elaborately designed to achieve a more powerful and efficient wash. You can see the excellent 3 rotating spray arm with 5 directional waterjet.

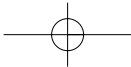

LD-4050W

3-2. Display Panel

RINSE / EXTRA HOT

- With each press, Rinse+, 77°C extra hot, Rinse+ & 77°C extra hot is repeated.

HALF LOAD

- In case of small load, use upper or lower rack only to save energy.
- With each press, can select upper or lower rack only.
- In case you don't select this button, the machine always works vario washing, which operate upper and lower spray arm alternately.

DIAL (PROGRAM & START / PAUSE)

- If you want to select program, rotate the dial clockwise or counter-clockwise.
- If you want to start cycle, press the dial.
- With each press, Start and Pause is repeated during operation.
- If the machine remains in Pause mode for 10 minutes, the power is automatically turned off.

TIME SAVE

- This function is for saving time and energy.
- With each press, time save ON and OFF is repeated.
- When select this function, the operating time will be shorten.

The diagram shows the control panel of the LD-4050W dishwasher. It includes a digital display with 'Temp.(°C)' and 'Time Left' indicators. The 'Temp.(°C)' display shows '50'. The 'Time Left' display shows '3:50'. Above the display are program buttons: Intensive, Auto, Economy, Gentle, Quick, Pre-wash, and Time Save. Below the display are buttons for Rinse, Half Load, Time Delay, Spray Intensity, Program Start/Pause, and Power. To the right of the display are options for Extra Hot, Upper, Lower, Strong, Normal, and Soft. Lines connect the descriptive text boxes to their corresponding physical controls on the panel.

CHILD LOCK

- Used to lock or unlock the control buttons to prevent all the setting from being changed by a child.
- For locking / unlocking, press Rinse and Half Load button simultaneously.

TIME DELAY

- If you want to delay the start of selected program, press this button before pressing start button.
- Pressing the delay time will increase time by 1 hour.
- The delay start time can be adjusted from 1 hour to 19 hours.

SPRAY INTENSITY

- With each press, the level of water jet is changed to “Strong”, “Normal”, and “Soft”.

POWER

- For operating, press this button first for power on.
- After operating, this button automatically switches off for safety and energy saving.
- If case of irregular surge disturbances to the machine, the power may be automatically turned off for safety.

- 7 -

LD-14AW2 / LD-14AT2

3-2. Display Panel

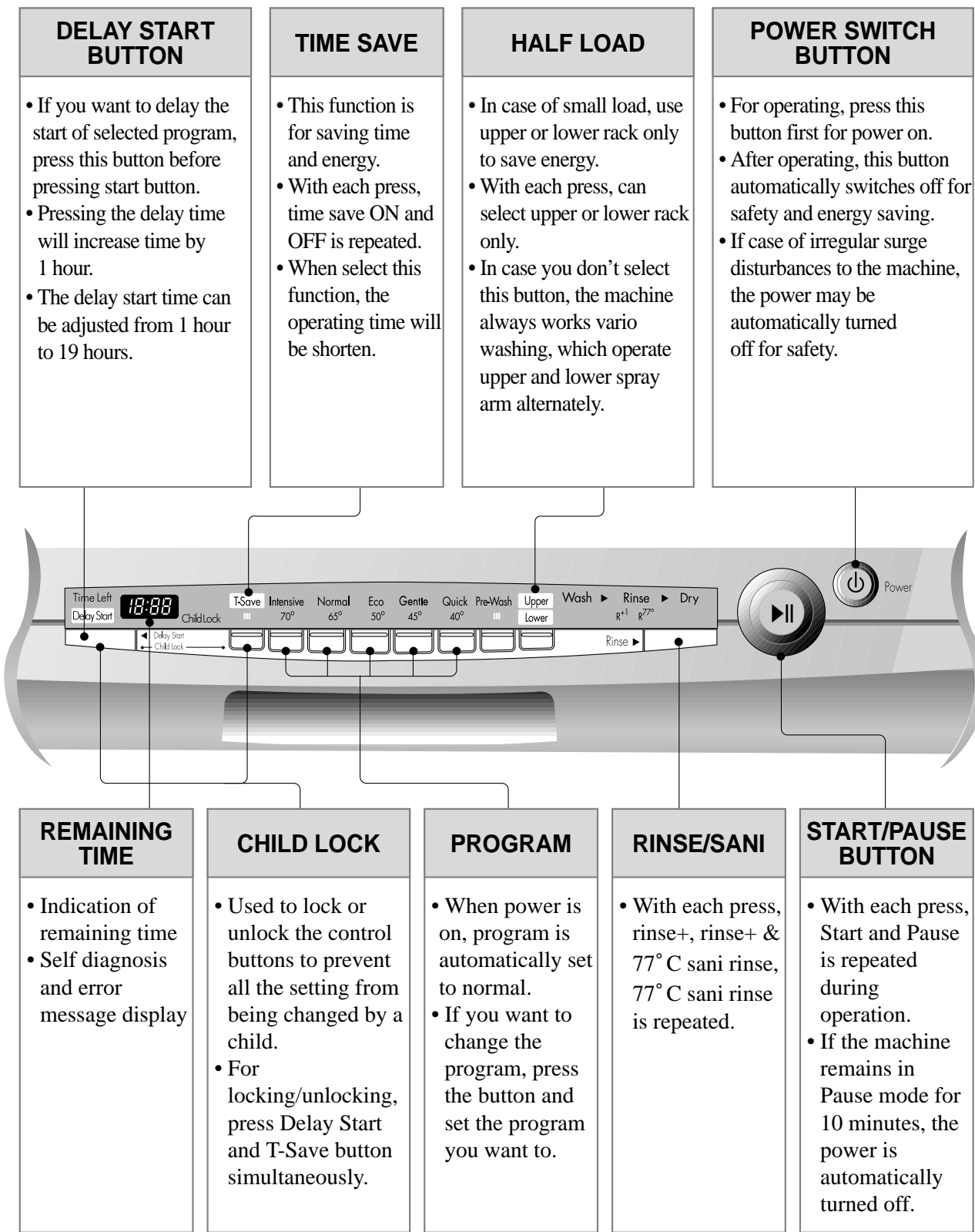

LD-4050W

3.3 TEST MODE

CHECK PROGRAM(START IN THE STATE OF THE CLOSED DOOR)

BUTTON	The number of pushing button	DISPLAY	Load and Checking points	
Half Load+Time Delay+POWER S/W	1 TIME	n : 0H	All LEDs are lighting	
Rinse	1 TIME	11 : 11	All LEDs are lighting	
Half Load	1 TIME	12 : 22	All LEDs are lighting	
Time Delay	1 TIME	13 : 33	All LEDs are lighting	
Multi Spray	1 TIME	14 : 44	All LEDs are lighting	
Time Save	1 TIME	15 : 55	All LEDs are lighting	
Dial knob	1 Rotation	11 : 11 ~ 16 : 66	The LED of each course is lighting	
Start/Pause	1 TIME	n : 01	None	Intensive
	2 TIME	Frequency	Water level sensor	Auto
	3 TIME	n : 03	Washing motor	Economy
	4 TIME	n : 04	Drain pump	Gentle
	5 TIME	n : 05	Inlet valve	Quick
	6 TIME	n : 06	Dispenser	Pre-wash
	7 TIME	n : 07	Heater(for 10 sec.)	Time Save
	8 TIME	n : 08	Fan motor	Wash
	9 TIME	n : 09	None	Rinse
	10 TIME	Temperature	Thermister	Dry
	11 TIME	n : 11	Lower Nozzle	Lower
	12 TIME	n : 12	Upper Nozzle	Upper
	13 TIME			AUTO OFF S/W

※ Micro S/W must be ON to operate HEATER

LD-14AT2/LD-14AW2

3.3 TEST MODE

CHECK PROGRAM(START IN THE STATE OF THE CLOSED DOOR)

BUTTON	The number of pushing button	DISPLAY	Load and Checking points	
Normal+Eco +POWER S/W	1 TIME	n : 0H	All LEDs are lighting	
Delay Start Key	1 TIME	11 : 11	All LEDs are lighting	
T-Save Key	1 TIME	12 : 22	All LEDs are lighting	
Intensive Key	1 TIME	13 : 33	All LEDs are lighting	
Normal Key	1 TIME	14 : 44	All LEDs are lighting	
Eco Key	1 TIME	15 : 55	All LEDs are lighting	
Gentle Key	1 TIME	11 : 11 ~ 16 : 66	All LEDs are lighting	
Quick Key	1 TIME	17 : 77	All LEDs are lighting	
Pre-Wash Key	1 TIME	18 : 88	All LEDs are lighting	
Half & Vario Key	1 TIME	19 : 99	All LEDs are lighting	
Rinse Key	1 TIME	10 : 00	All LEDs are lighting	
Start/Pause	1 TIME	n : 01	None	Time Save
	2 TIME	Frequency	Water level sensor	Intensive
	3 TIME	n : 03	Washing motor	Normal
	4 TIME	n : 04	Drain pump	Eco
	5 TIME	n : 05	Inlet valve	Quick
	6 TIME	n : 06	Dispenser	Pre-wash
	7 TIME	n : 07	Heater(for 10 sec.)	Wash 1
	8 TIME	n : 08	Fan motor	Wash 2
	9 TIME	n : 09	None	Rinse 1
	10 TIME	Temperature	Thermister	Rinse 2
	11 TIME	n : 11	Lower Nozzle	Dry
	12 TIME	n : 12	Upper Nozzle	
	13 TIME			AUTO OFF S/W

※ Micro S/W must be ON to operate HEATER

4. PARTS NAME

LD-4050W

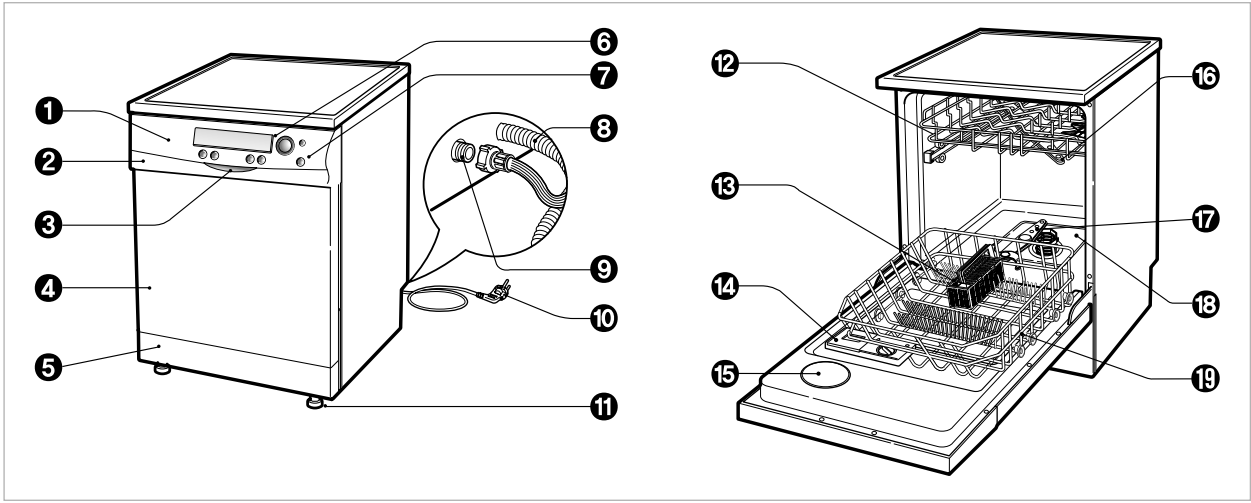

- | | |
|--------------------|-------------------------------------|
| 1. Control Panel | 11. Adjust Leg |
| 2. Vapor vent | 12. Upper Rack |
| 3. Door Handle | 13. Cutlery Rack |
| 4. Front Cover | 14. Detergent & Rinse Aid Dispenser |
| 5. Lower Cover | 15. Vapor Vent Cover |
| 6. Process Monitor | 16. Upper Spray Arm |
| 7. Power Switch | 17. Lower Spray Arm |
| 8. Drain hose | 18. Filter ASM |
| 9. Inlet valve ASM | 19. Lower Rack |
| 10. Power Cord | |

Accessories

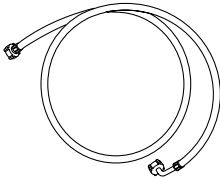

Inlet Hose

4. PARTS NAME

LD-14AT2/LD-14AW2

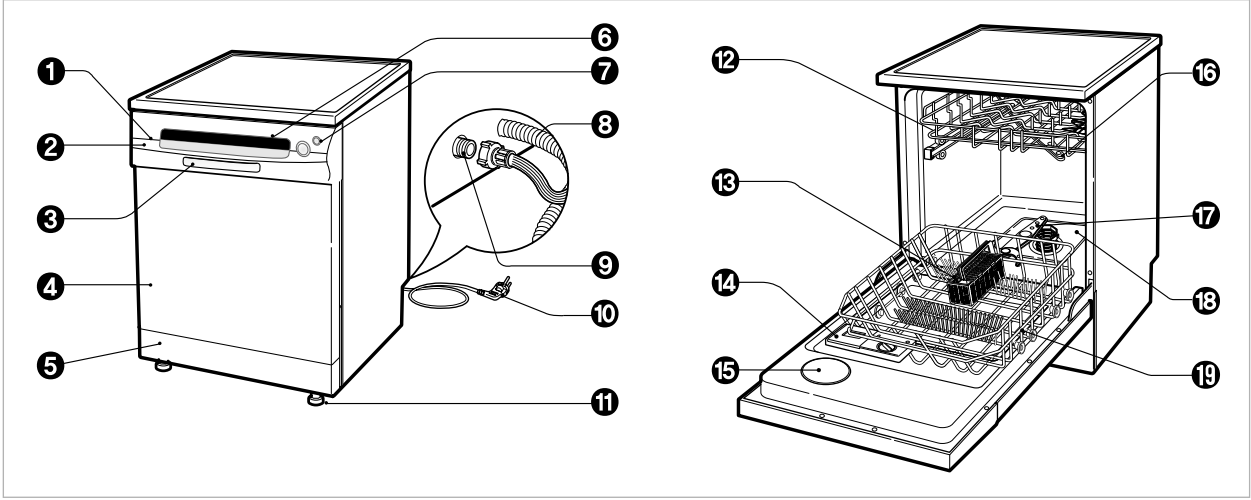

- | | |
|-------------------------|-------------------------------------|
| 1. Vapor vent | 11. Adjust Leg |
| 2. Control Panel | 12. Upper Rack |
| 3. Door Handle | 13. Cutlery Rack |
| 4. Front Cover | 14. Detergent & Rinse Aid Dispenser |
| 5. Lower Cover | 15. Vapor Vent Cover |
| 6. Process Monitor | 16. Upper Spray Arm |
| 7. Power Switch | 17. Lower Spray Arm |
| 8. Inlet valve ASM | 18. Filter ASM |
| 9. Drain Hose Connector | 19. Lower Rack |
| 10. Power Cord | |

Accessories

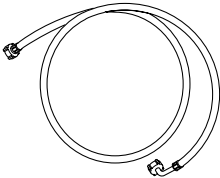

Inlet Hose

5. WIRING DIAGRAM

LD-4050W

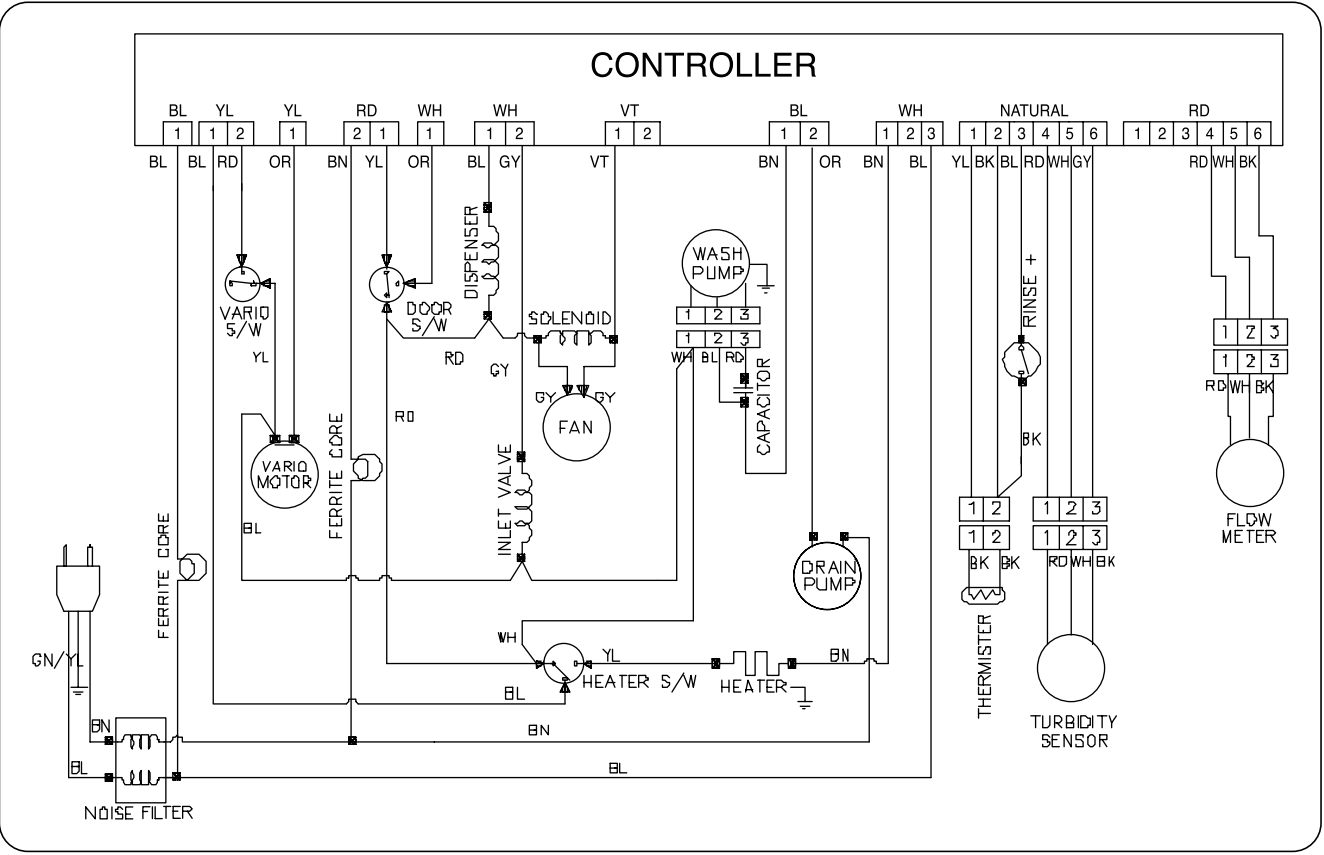

5. WIRING DIAGRAM

LD-14AW2

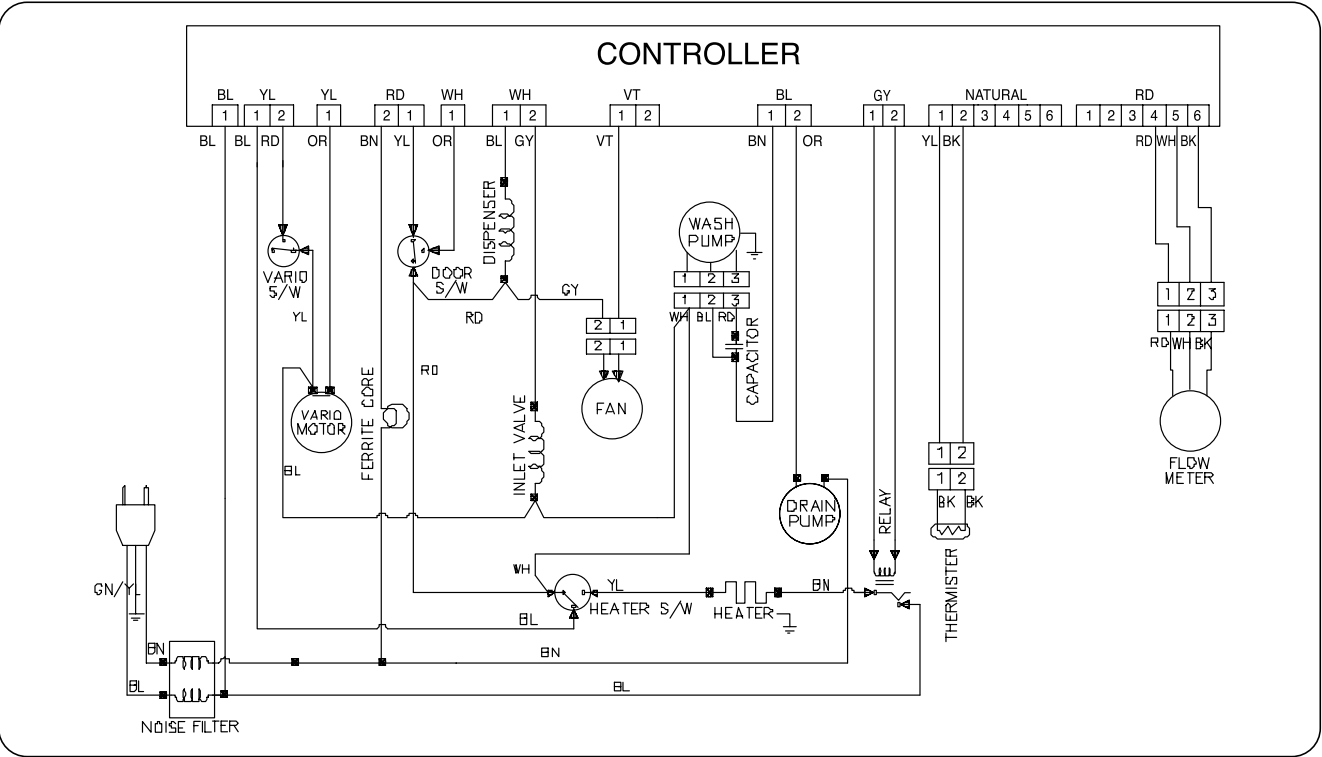

LD-14AT2

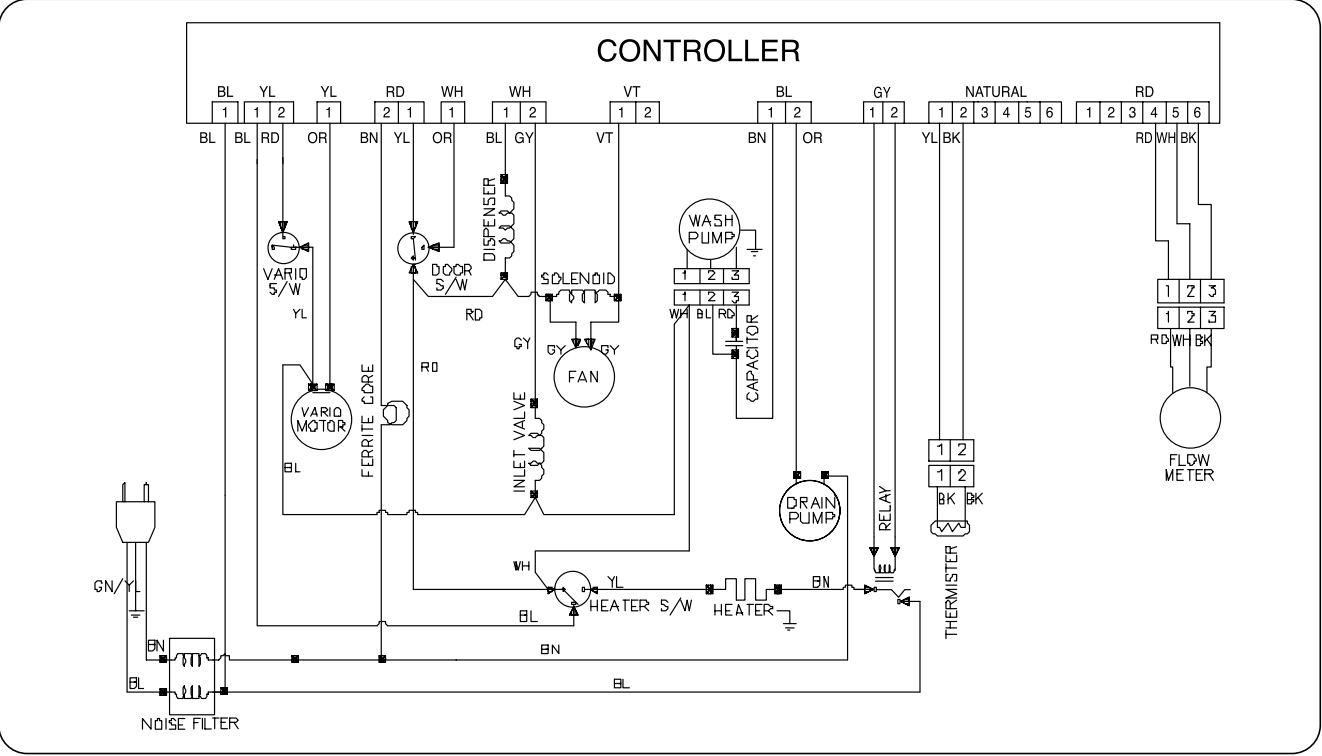

6. PROGRAM CHART(SCHEMATIC DIAGRAM)

Program chart

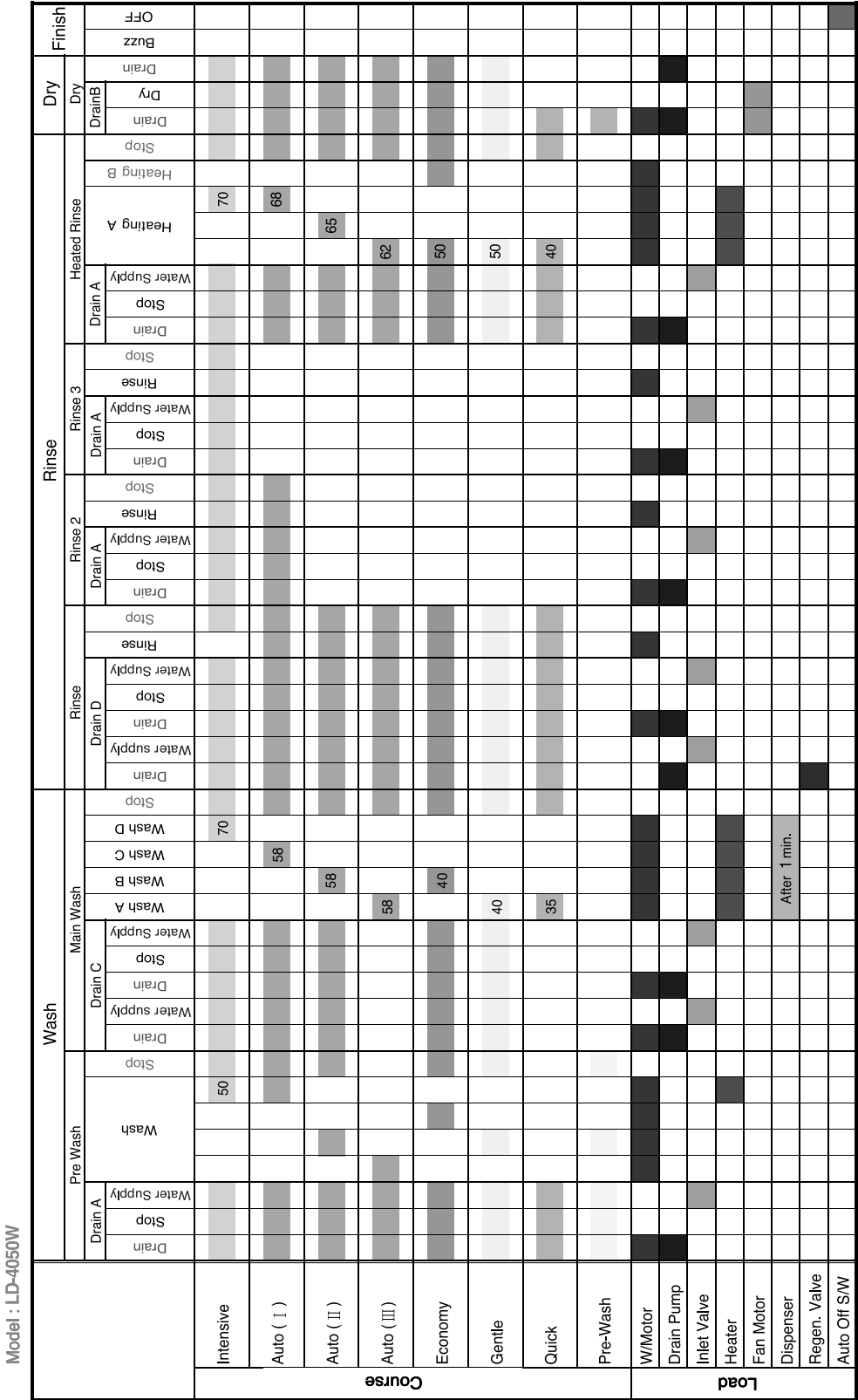

6. PROGRAM CHART(PGM TIME Flow-Default, Vario)

Program chart

Course		Wash															Rinse										Dry		Finish																																																																																																																																																																																																																																																																																																																																																																																																																																																																																																																																																																																																																																																																																																																																																																																																																																																			
		Pre Wash					Main Wash					Rinse					Rinse1					Rinse2					Heated Rinse					Dry																																																																																																																																																																																																																																																																																																																																																																																																																																																																																																																																																																																																																																																																																																																																																																																																																																																
		Drain	Stop	Water Supply	Drain	Stop	Water supply	Drain	Stop	Water Supply	Drain	Stop	Drain	Stop	Water Supply	Drain	Stop	Drain	Stop	Water Supply	Drain	Stop	Drain	Stop	Water Supply	Drain	Stop	Drain		Stop	Water Supply	Drain	Stop	Drain	Stop	Water Supply	Drain	Stop	Drain	Stop	Water Supply	Drain	Stop	Drain	Stop	Water Supply	Drain	Stop	Drain	Stop	Water Supply	Drain	Stop	Drain	Stop	Water Supply	Drain	Stop	Drain	Stop	Water Supply	Drain	Stop	Drain	Stop	Water Supply	Drain	Stop	Drain	Stop	Water Supply	Drain	Stop	Drain	Stop	Water Supply	Drain	Stop	Drain	Stop	Water Supply	Drain	Stop	Drain	Stop	Water Supply	Drain	Stop	Drain	Stop	Water Supply	Drain	Stop	Drain	Stop	Water Supply	Drain	Stop	Drain	Stop	Water Supply	Drain	Stop	Drain	Stop	Water Supply	Drain	Stop	Drain	Stop	Water Supply	Drain	Stop	Drain	Stop	Water Supply	Drain	Stop	Drain	Stop	Water Supply	Drain	Stop	Drain	Stop	Water Supply	Drain	Stop	Drain	Stop	Water Supply	Drain	Stop	Drain	Stop	Water Supply	Drain	Stop	Drain	Stop	Water Supply	Drain	Stop	Drain	Stop	Water Supply	Drain	Stop	Drain	Stop	Water Supply	Drain	Stop	Drain	Stop	Water Supply	Drain	Stop	Drain	Stop	Water Supply	Drain	Stop	Drain	Stop	Water Supply	Drain	Stop	Drain	Stop	Water Supply	Drain	Stop	Drain	Stop	Water Supply	Drain	Stop	Drain	Stop	Water Supply	Drain	Stop	Drain	Stop	Water Supply	Drain	Stop	Drain	Stop	Water Supply	Drain	Stop	Drain	Stop	Water Supply	Drain	Stop	Drain	Stop	Water Supply	Drain	Stop	Drain	Stop	Water Supply	Drain	Stop	Drain	Stop	Water Supply	Drain	Stop	Drain	Stop	Water Supply	Drain	Stop	Drain	Stop	Water Supply	Drain	Stop	Drain	Stop	Water Supply	Drain	Stop	Drain	Stop	Water Supply	Drain	Stop	Drain	Stop	Water Supply	Drain	Stop	Drain	Stop	Water Supply	Drain	Stop	Drain	Stop	Water Supply	Drain	Stop	Drain	Stop	Water Supply	Drain	Stop	Drain	Stop	Water Supply	Drain	Stop	Drain	Stop	Water Supply	Drain	Stop	Drain	Stop	Water Supply	Drain	Stop	Drain	Stop	Water Supply	Drain	Stop	Drain	Stop	Water Supply	Drain	Stop	Drain	Stop	Water Supply	Drain	Stop	Drain	Stop	Water Supply	Drain	Stop	Drain	Stop	Water Supply	Drain	Stop	Drain	Stop	Water Supply	Drain	Stop	Drain	Stop	Water Supply	Drain	Stop	Drain	Stop	Water Supply	Drain	Stop	Drain	Stop	Water Supply	Drain	Stop	Drain	Stop	Water Supply	Drain	Stop	Drain	Stop	Water Supply	Drain	Stop	Drain	Stop	Water Supply	Drain	Stop	Drain	Stop	Water Supply	Drain	Stop	Drain	Stop	Water Supply	Drain	Stop	Drain	Stop	Water Supply	Drain	Stop	Drain	Stop	Water Supply	Drain	Stop	Drain	Stop	Water Supply	Drain	Stop	Drain	Stop	Water Supply	Drain	Stop	Drain	Stop	Water Supply	Drain	Stop	Drain	Stop	Water Supply	Drain	Stop	Drain	Stop	Water Supply	Drain	Stop	Drain	Stop	Water Supply	Drain	Stop	Drain	Stop	Water Supply	Drain	Stop	Drain	Stop	Water Supply	Drain	Stop	Drain	Stop	Water Supply	Drain	Stop	Drain	Stop	Water Supply	Drain	Stop	Drain	Stop	Water Supply	Drain	Stop	Drain	Stop	Water Supply	Drain	Stop	Drain	Stop	Water Supply	Drain	Stop	Drain	Stop	Water Supply	Drain	Stop	Drain	Stop	Water Supply	Drain	Stop	Drain	Stop	Water Supply	Drain	Stop	Drain	Stop	Water Supply	Drain	Stop	Drain	Stop	Water Supply	Drain	Stop	Drain	Stop	Water Supply	Drain	Stop	Drain	Stop	Water Supply	Drain	Stop	Drain	Stop	Water Supply	Drain	Stop	Drain	Stop	Water Supply	Drain	Stop	Drain	Stop	Water Supply	Drain	Stop	Drain	Stop	Water Supply	Drain	Stop	Drain	Stop	Water Supply	Drain	Stop	Drain	Stop	Water Supply	Drain	Stop	Drain	Stop	Water Supply	Drain	Stop	Drain	Stop	Water Supply	Drain	Stop	Drain	Stop	Water Supply	Drain	Stop	Drain	Stop	Water Supply	Drain	Stop	Drain	Stop	Water Supply	Drain	Stop	Drain	Stop	Water Supply	Drain	Stop	Drain	Stop	Water Supply	Drain	Stop	Drain	Stop	Water Supply	Drain	Stop	Drain	Stop	Water Supply	Drain	Stop	Drain	Stop	Water Supply	Drain	Stop	Drain	Stop	Water Supply	Drain	Stop	Drain	Stop	Water Supply	Drain	Stop	Drain	Stop	Water Supply	Drain	Stop	Drain	Stop	Water Supply	Drain	Stop	Drain	Stop	Water Supply	Drain	Stop	Drain	Stop	Water Supply	Drain	Stop	Drain	Stop	Water Supply	Drain	Stop	Drain	Stop	Water Supply	Drain	Stop	Drain	Stop	Water Supply	Drain	Stop	Drain	Stop	Water Supply	Drain	Stop	Drain	Stop	Water Supply	Drain	Stop	Drain	Stop	Water Supply	Drain	Stop	Drain	Stop	Water Supply	Drain	Stop	Drain	Stop	Water Supply	Drain	Stop	Drain	Stop	Water Supply	Drain	Stop	Drain	Stop	Water Supply	Drain	Stop	Drain	Stop	Water Supply	Drain	Stop	Drain	Stop	Water Supply	Drain	Stop	Drain	Stop	Water Supply	Drain	Stop	Drain	Stop	Water Supply	Drain	Stop	Drain	Stop	Water Supply	Drain	Stop	Drain	Stop	Water Supply	Drain	Stop	Drain	Stop	Water Supply	Drain	Stop	Drain	Stop	Water Supply	Drain	Stop	Drain	Stop	Water Supply	Drain	Stop	Drain	Stop	Water Supply	Drain	Stop	Drain	Stop	Water Supply	Drain	Stop	Drain	Stop	Water Supply	Drain	Stop	Drain	Stop	Water Supply	Drain	Stop	Drain	Stop	Water Supply	Drain	Stop	Drain	Stop	Water Supply	Drain	Stop	Drain	Stop	Water Supply	Drain	Stop	Drain	Stop	Water Supply	Drain	Stop	Drain	Stop	Water Supply	Drain	Stop	Drain	Stop	Water Supply	Drain	Stop	Drain	Stop	Water Supply	Drain	Stop	Drain	Stop	Water Supply	Drain	Stop	Drain	Stop	Water Supply	Drain	Stop	Drain	Stop	Water Supply	Drain	Stop	Drain	Stop	Water Supply	Drain	Stop	Drain	Stop	Water Supply	Drain	Stop	Drain	Stop	Water Supply	Drain	Stop	Drain	Stop	Water Supply	Drain	Stop	Drain	Stop	Water Supply	Drain	Stop	Drain	Stop	Water Supply	Drain	Stop	Drain	Stop	Water Supply	Drain	Stop	Drain	Stop	Water Supply	Drain	Stop	Drain	Stop	Water Supply	Drain	Stop	Drain	Stop	Water Supply	Drain	Stop	Drain	Stop	Water Supply	Drain	Stop	Drain	Stop	Water Supply	Drain	Stop	Drain	Stop	Water Supply	Drain	Stop	Drain	Stop	Water Supply	Drain	Stop	Drain	Stop	Water Supply	Drain	Stop	Drain	Stop	Water Supply	Drain	Stop	Drain	Stop	Water Supply	Drain	Stop	Drain	Stop	Water Supply	Drain	Stop	Drain	Stop	Water Supply	Drain	Stop	Drain	Stop	Water Supply	Drain	Stop	Drain	Stop	Water Supply	Drain	Stop	Drain	Stop	Water Supply	Drain	Stop	Drain	Stop	Water Supply	Drain	Stop	Drain	Stop	Water Supply	Drain	Stop	Drain	Stop	Water Supply	Drain	Stop

Note : The figure in the process of each course means temperature of each process

7. HOW TO DISASSEMBLE

BEFORE DISASSEMBLING THE DISHWASHER ;

- 1) Remove the plug from electric outlet to avoid electric shock.
- 2) Close the Water Tap(faucet).
- 3) Remove all dishes and items in the dishwasher.
- 4) Remove the Lower Rack and the Upper Rack.
- 5) If necessary, remove the inlet hose and drain hose to avoid the hose damages.
- 6) Prepare some towels to avoid floor wet by the water left in the dishwasher.

7-1. FULL DISASSEMBLE

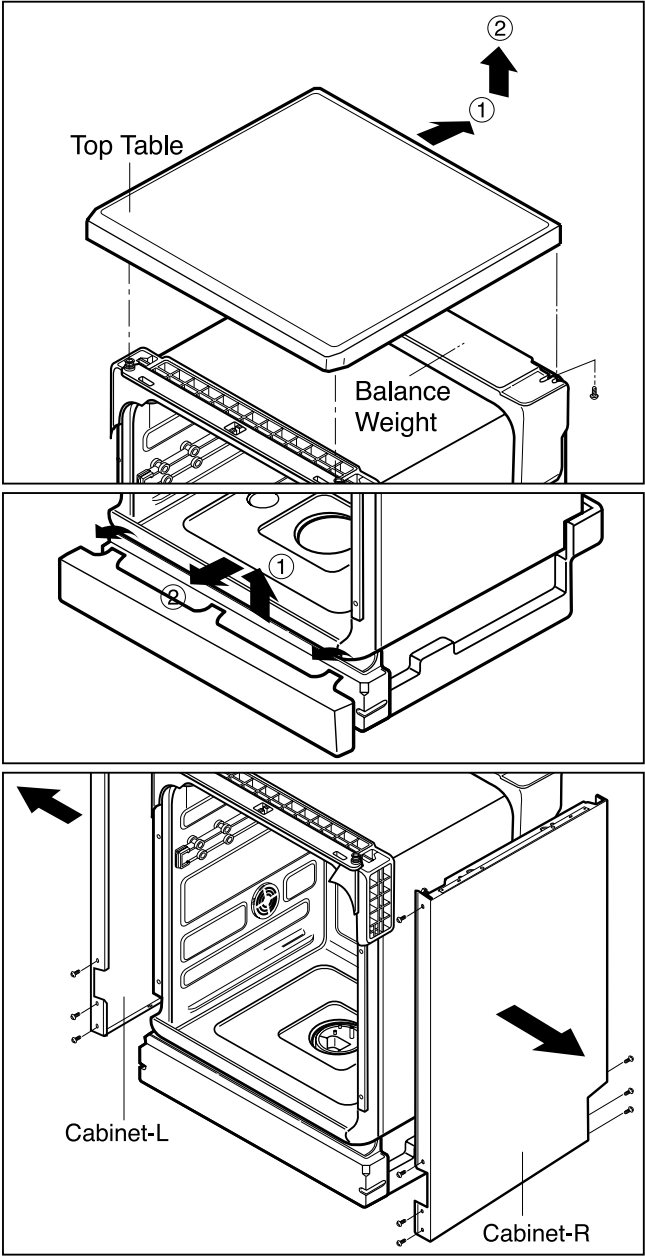

1. Top Table

- 1) Remove the rear 2 screws.
- 2) Pull and lift the top table.

2. Low Cover

3. Cabinet-R/L

- 1) **Cabinet-R**
 - ① Remove front 4 screws.
 - ② Remove rear 3 screws.
- 2) **Cabinet-L**
 - ① Remove front 4 screws.
 - ② Remove rear 3 screws.

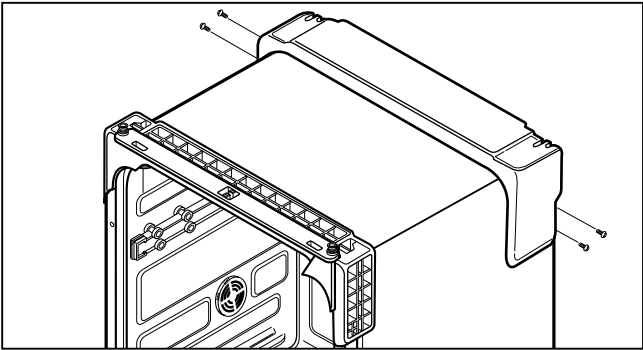

4. Balance weight

- 1) Remove side 4 screws.
- 2) Lift the balance weight.

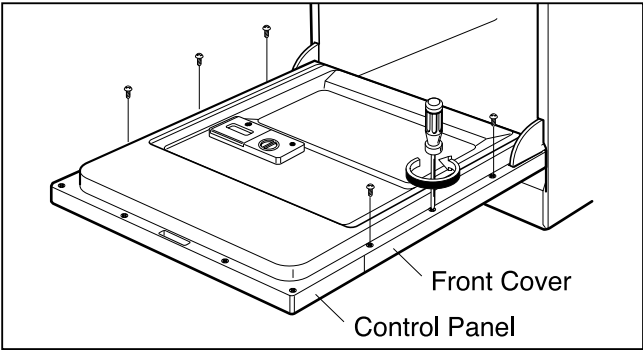

5. Door Assembly

1) Front Cover

- ① Open the door.
- ② Remove 6 screws(stainless).
- ③ Close the door slowly and remove front cover downwards.

2) Control Panel Assembly

- ① Open the door.
- ② Remove 4 screws(stainless).
- ③ Remove wire connection.
※ Be sure the wiring should not be changed in reassembling.
- ④ Remove 3 screws for Latch assembly
- ⑤ Remove 5 screws for Controller.

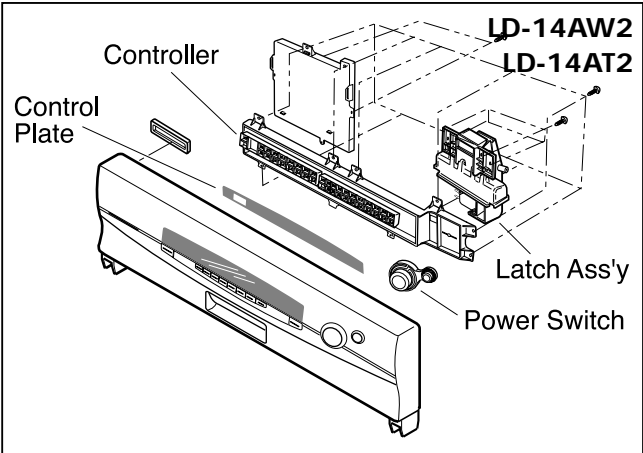
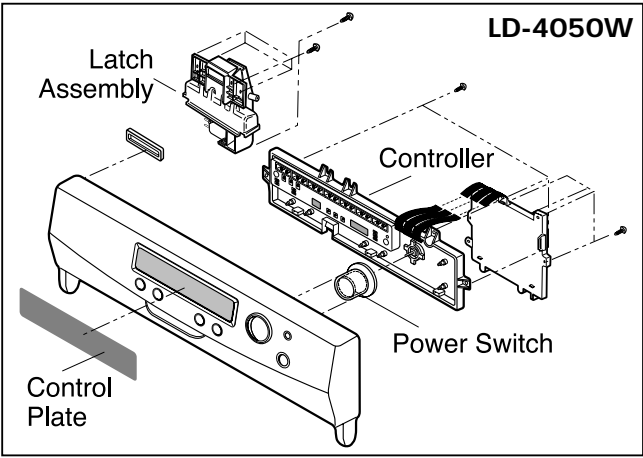

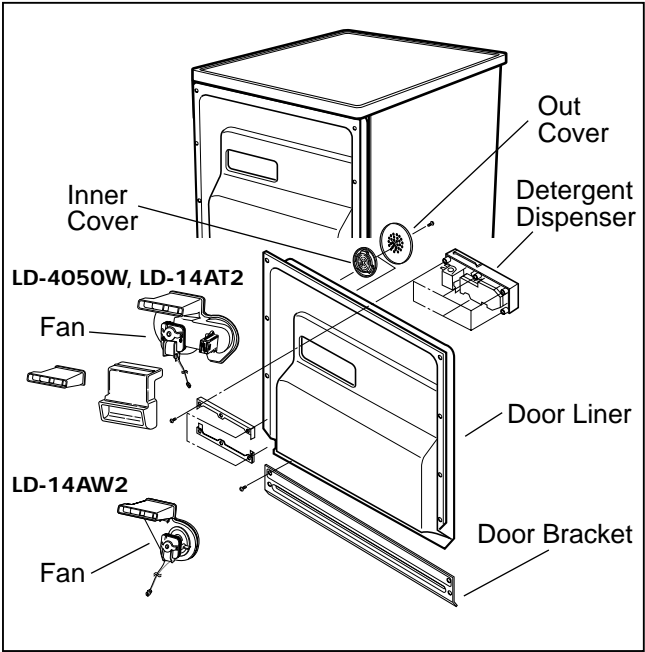

3) Fan

- ① Open the door.
- ② Remove the outer cover by removing 1 screw.
- ③ Remove 2 fixing screws inside and turn the Inner Cover counterclockwise.

4) Detergent Dispenser

- ① Close the door.
- ② Remove the wire connections.
- ③ Remove 6 screws with brackets.

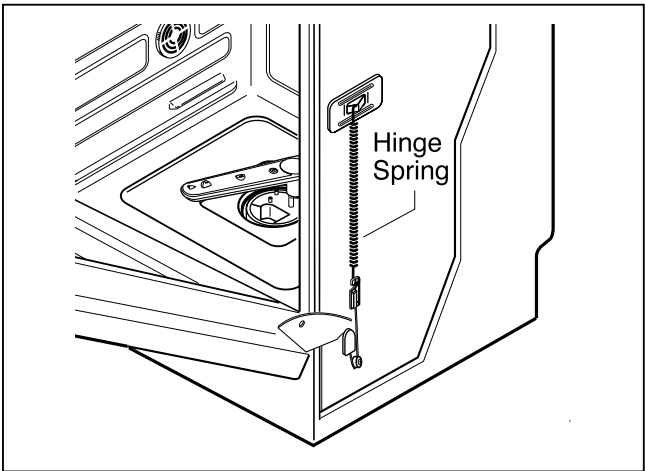

5) Door Spring (Right & Left)

- ① Push the Spring upwards and take it off from the Frame.
- ※ Be careful not to be injured by the sharp edge of Tub.
- ② Take the Hinge Link off from the Hinge.

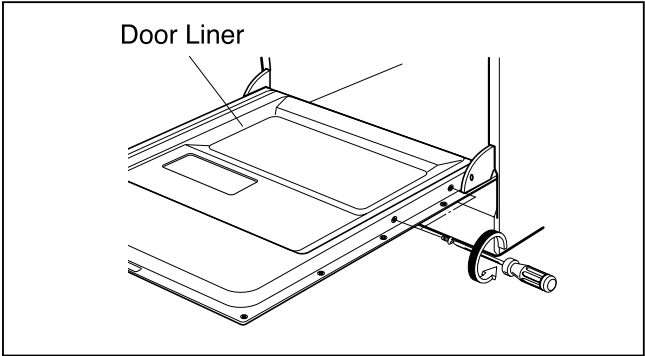

6) Door Liner

- ① Open the door.
- ② Remove 4 screws.
- ※ Do not use other screws for assembling.

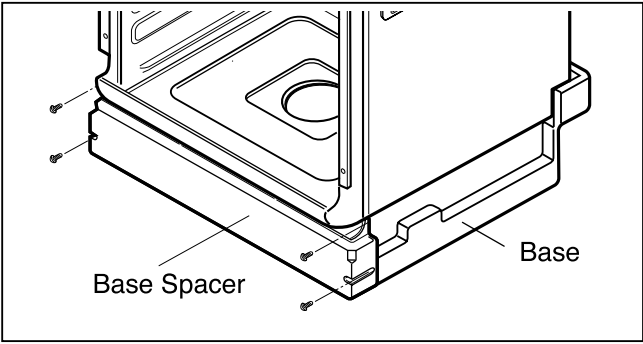

6. Base spacer

- ① Remove 4 screws.
- ② Lift the front side of dishwasher and pull the base spacer forward.

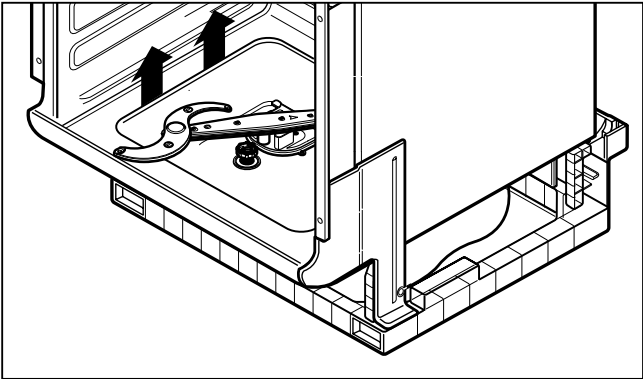

7. Tub assembly

1) Nozzle

- ① Pull up the nozzle.

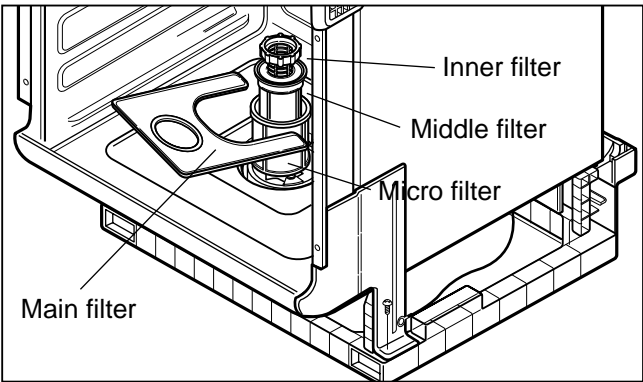

2) Filter Assembly

- ① Turn inner filter counterclockwise and lift inner filter and middle filter.
※ You can disassemble inner filter and middle filter by pulling opposite direction.
- ② Lift up main filter.
- ③ Lift up micro filter.

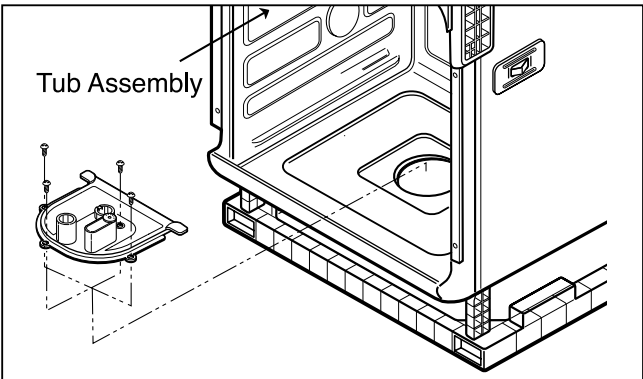

3) Nozzle Holder

- ① Disconnect the water guide
- ② Remove 4 screws and lift it up

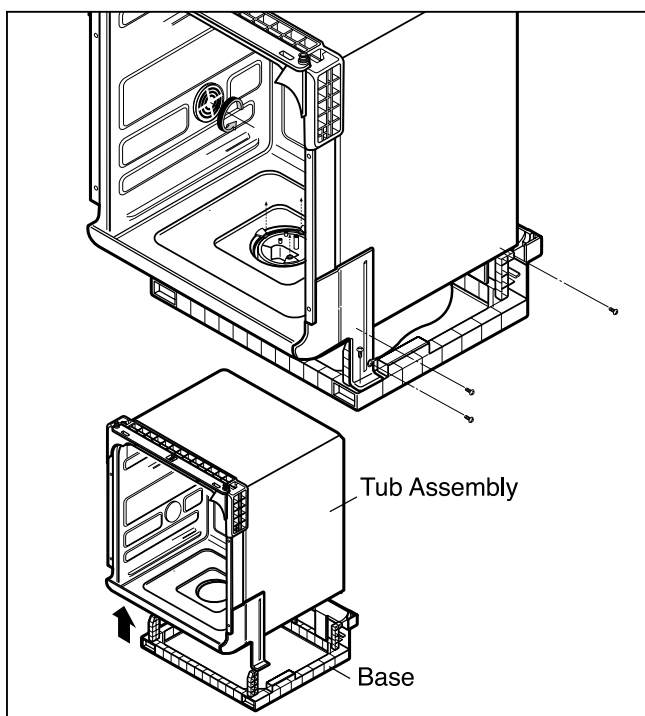

4) Tub

- ① Turn the air guide nut counter-clockwise.
(Special tool might be needed.)
- ※ Be careful the rubber packing of air guide assembly should not be lost.
- ② Remove 4 screws for sump holder .
- ③ Remove side 8 screws.
- ④ Remove 2 Earth screw of right side.
- ⑤ Lift tub assembly upward.
- ※ Be careful not to be injured or scratch floor by the sharp edge of tub.

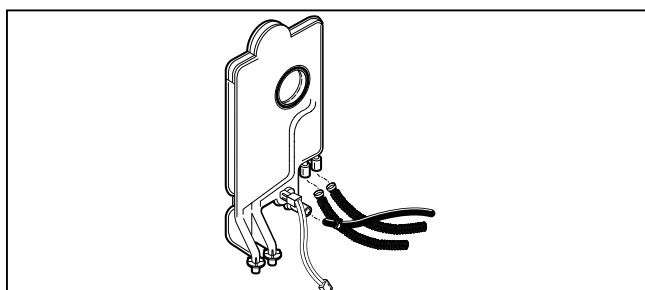

8. Air Guide Assembly

- ① Disconnect the wiring connection.
- ② Remove 3 hoses assembly.
- ※ Be careful the o-ring should not be lost.

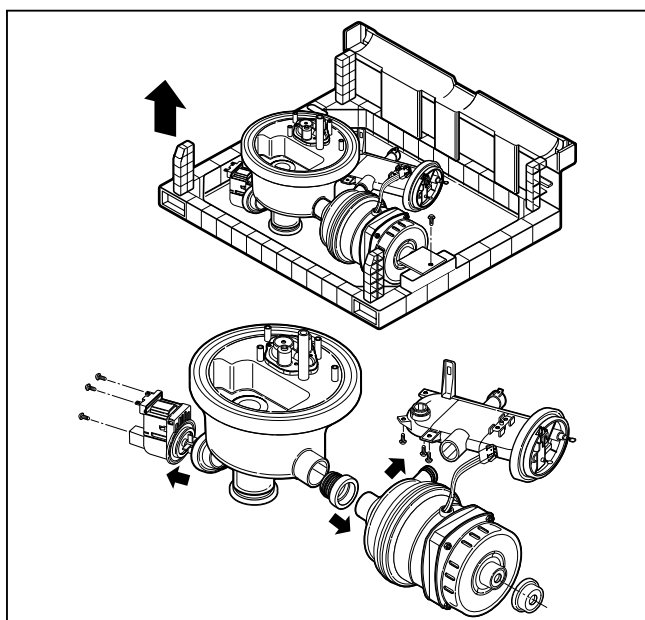

9. C-Base Assembly

- 1) Remove the screw which tighten washing motor and base.
- 2) Lift them upward.
※ Be careful not to wet the floor by the water left in the sump.
- 3) Detach the washing motor and heater assembly by pulling opposite direction to sump.
- 4) Remove the 3 screw for drain motor.

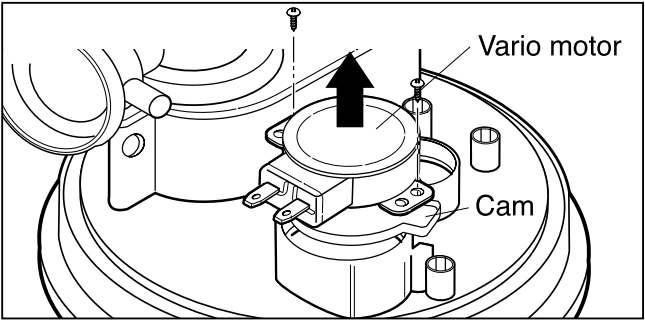

5) synchronous motor

- ① Remove the 2 screws.
- ② Lift the cam upward.
- ※ Be careful not to install upside down.
(part number on the cam should face the motor.)

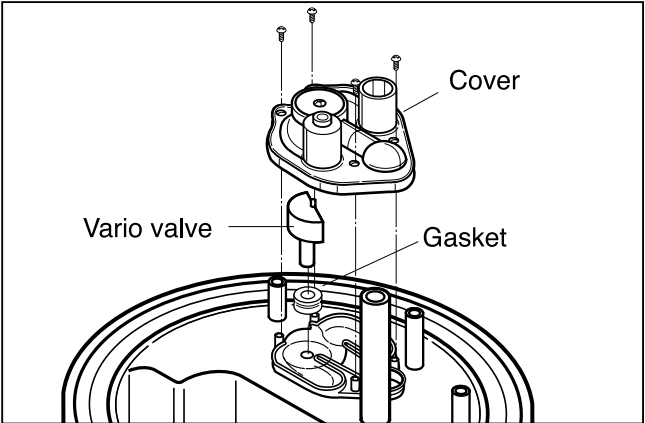

6) Vario valve

- ① Remove 4 screws and lift the cover upward.
- ② Lift the vario valve upward.

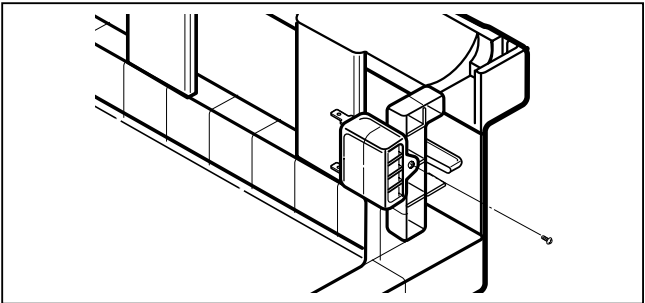

7) Capacitor

- ① Remove 1 screw.

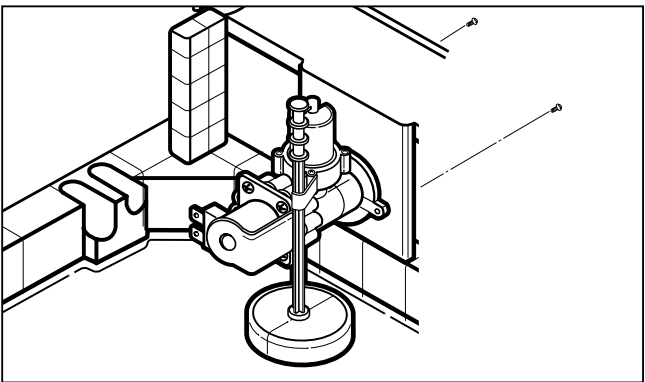

8) Inlet valve

- ① Remove 2 screws.

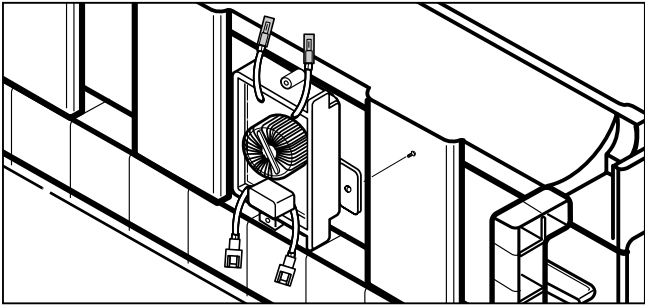

9) Noise filter

- ① Remove 1 screw.

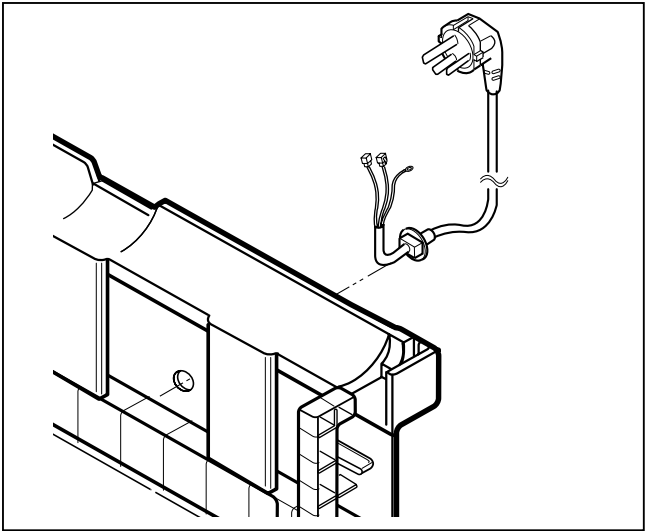

10) Power cord assembly

- ① Turn the power cord assembly 90° and take it off.

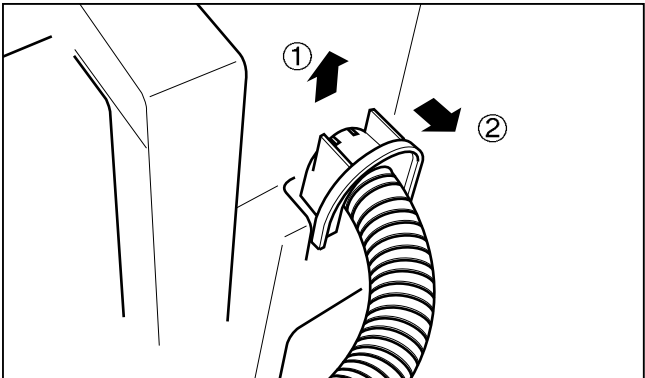

11) Drain Hose

- ① Pull the holder forward and upward.

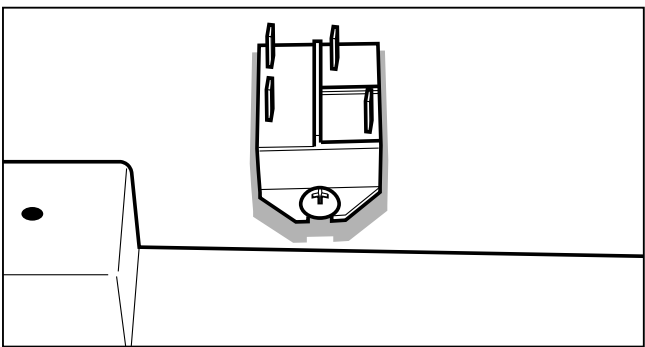

12) Relay

- ① Remove 2 screws.
- ※ LD-4050W has no relay.

7-2. DISASSEMBLE C-BASE ASSEMBLY

1. Top Plate

- See 7-1. 1. (Page 17)

2. Low Cover

- See 7-1. 2. (Page 17)

3. Cabinet-R/L

- See 7-1. 3. (Page 17)

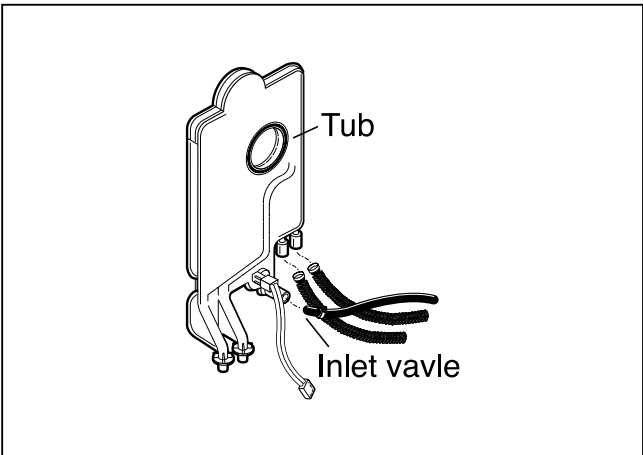

4. Air Guide

- ① Disconnect 3 hoses assembly.
- ※ You need not to unscrew the air guide nut.

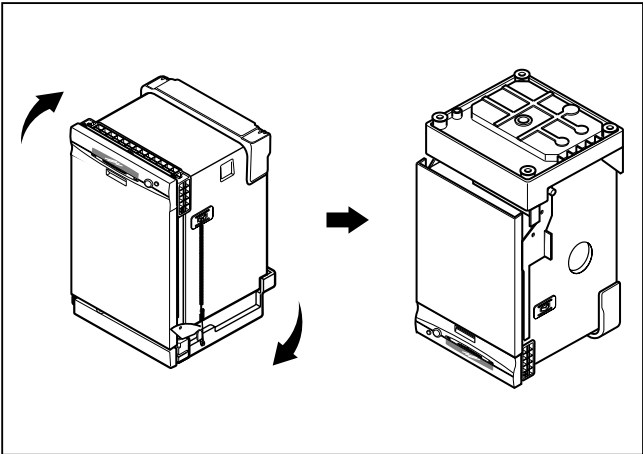

5. Put the Dishwasher upside down.

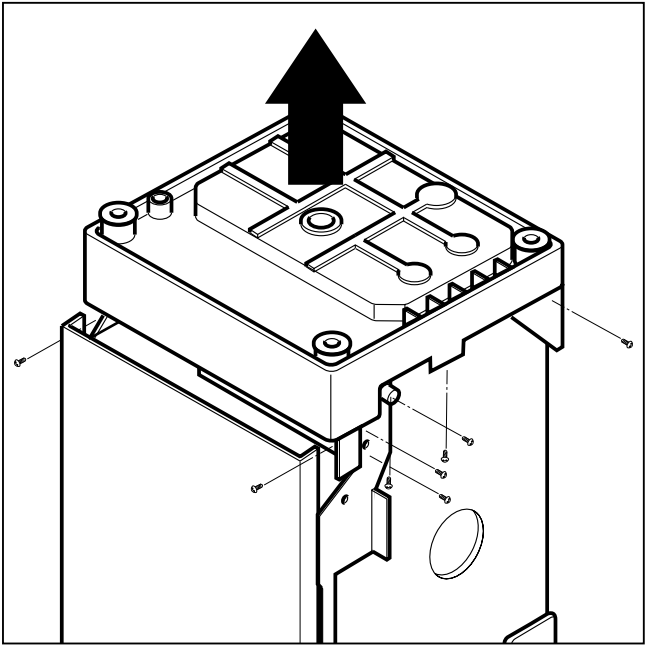

6. Remove the side screws

- 1) Remove side 8 screws.
- 2) Remove 2 Earth screws of right side.
- 3) Remove 1 motor bracket screw.
- 4) Lift base upward slightly.
(You can't lift up base perfectly because of some parts connecting to base.)

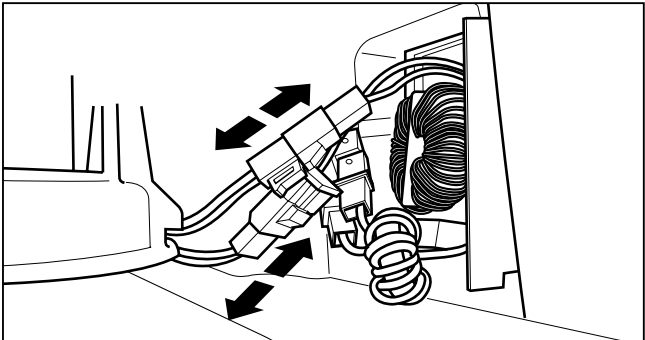

7. Disconnect the connecting points between tub and base

- 1) Disconnect noise filter.
- 2) Disconnect of powercord assembly.

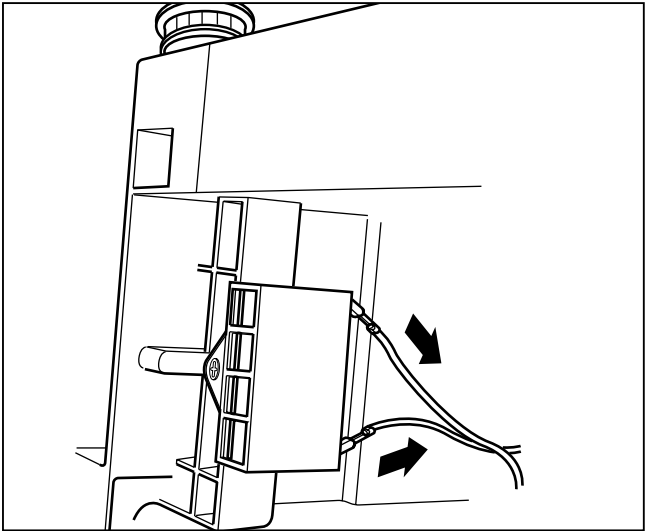

- 3) Disconnect wire from the capacity.

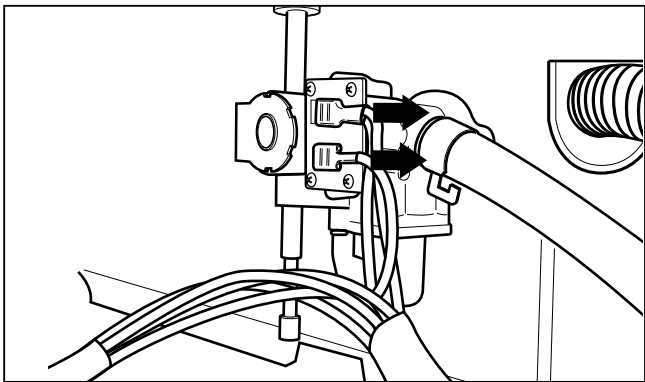

4) Disconnect wire from the inlet valve.

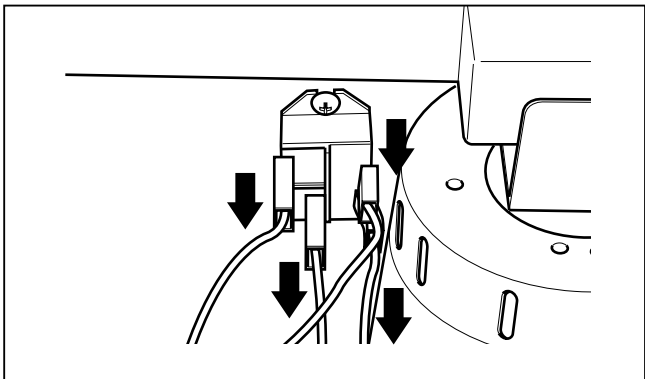

5) Disconnect wire from the relay.

※ Now, you can remove the base from the tub perfectly.

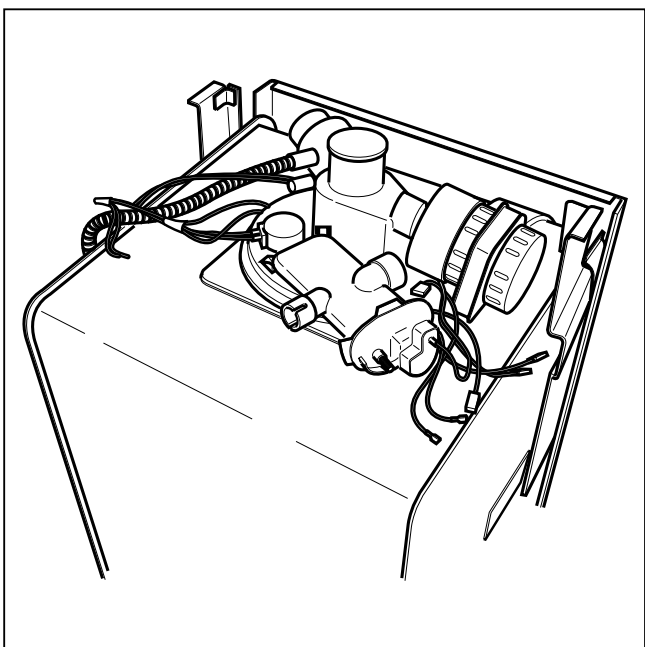

8. C-Base Assembly

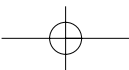

※ You can repair the parts in the C-Base like heater case, washing pump, drain motor etc. you may refer to 7-1. 9. 2)~11) (Page 21~23)

※ Don't disassemble sump by 7-2.
If you want to disassemble the sump, follow 7-1.





8.TROUBLE SHOOTING METHODS

A. TROUBLE SHOOTING ACCORDING TO DISPLAYED ERROR MESSAGE

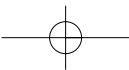
ERROR MESSAGE	POSSIBLE CAUSE FOR ERROR OCCURRENCE	REMEDY
<div>INLET ERROR</div> <div></div> <div>displayed</div> <div>Condition</div> <div>Not reached to the normal water level in spite of 10 min. water supply</div>	<ul style="list-style-type: none">• The Water Tap is not opened.• The Inlet Hose is kinked.• The Filter of inlet valve clogged by impure water.• The Inlet Water Valve is normal ?• The water pressure is very low. (below 0.5 kgf/cm²)• Inlet valve is blocked by safety device for leakage sensing.	<ul style="list-style-type: none">• Open the Water Tap.• Repair the Inlet Hose.• a) Close the Water Tap. b) Unscrew the Inlet Hose (Inlet Valve side) c) Clean the Filter of Inlet Valve.• Replace or repair the Inlet Valve.• Check the water remain on the base. 1) Check the point of damages and repair or replace the related parts. 2) Disconnect the inlet hose to dishwasher to unlock the safety valve.
<div>DRAIN ERROR</div> <div></div> <div>displayed</div> <div>Condition</div> <div>Not fully drained out in spite of 5 min. drain operation</div>	<ul style="list-style-type: none">• The Filter clogged.• The Drain Hose kinked or blocked.• The Drain Pump/Motor or circuit is troubled.	<ul style="list-style-type: none">• Clean the Filter.• Remove the cause of kink or block.• Replace the Drain Pump/Motor or repair the Circuit.
<div>LEAKAGE ERROR</div> <div></div> <div>displayed</div> <div>Condition</div> <div>The water level in Tub goes down during operation</div>	<ul style="list-style-type: none">• Water leakage in Hose connections.• Water is leaked by damages.	<ul style="list-style-type: none">• Replace the connections of Hose.• Check the point of damages and repair or replace the related parts.



ERROR MESSAGE	POSSIBLE CAUSE FOR ERROR OCCURRENCE	REMEDY
<div>EXCESS ERROR</div> <div></div> <div>displayed</div> <div>Condition</div> <div>Excessive water is supplied than normal water level.(Automatically drain Pump operated.)</div>	<div><ul style="list-style-type: none">• The Inlet Valve is troubled.• The Air Break is troubled.• The Sensor Assembly is troubled.• The Controller is troubled.</div>	<div><ul style="list-style-type: none">• Replace the Inlet Valve.• Replace the air breaker.• Replace the sensor assembly.• Repair or replace the Controller.</div>
<div>THERMAL ERROR</div> <div></div> <div>displayed</div> <div>Condition</div> <div>The resistance of thermistor not normally out put.</div>	<div><ul style="list-style-type: none">• The Circuit of thermistor is troubled.• Thermistor is troubled.• The Controller is troubled.</div>	<div><ul style="list-style-type: none">• Repair the Circuit of thermistor.• Replace the Thermistor.• Repair or replace the Controller.</div>
<div>HEATER ERROR</div> <div></div> <div>displayed</div> <div>Condition</div> <div>The water is not heated or the temperature in the Tub is overheated to over 95j</div>	<div><ul style="list-style-type: none">• The Circuit of Heater is troubled.• The Thermistor is troubled.• The Heater is shorted.• The Relay Circuit is troubled.</div>	<div><ul style="list-style-type: none">• Repair the Circuit of Heater.• Replace the Thermistor.• Replace the Heater.• Repair the Relay Circuit..</div>

B. TROUBLE DIAGNOSES AND REPAIR BY SYMPTOM

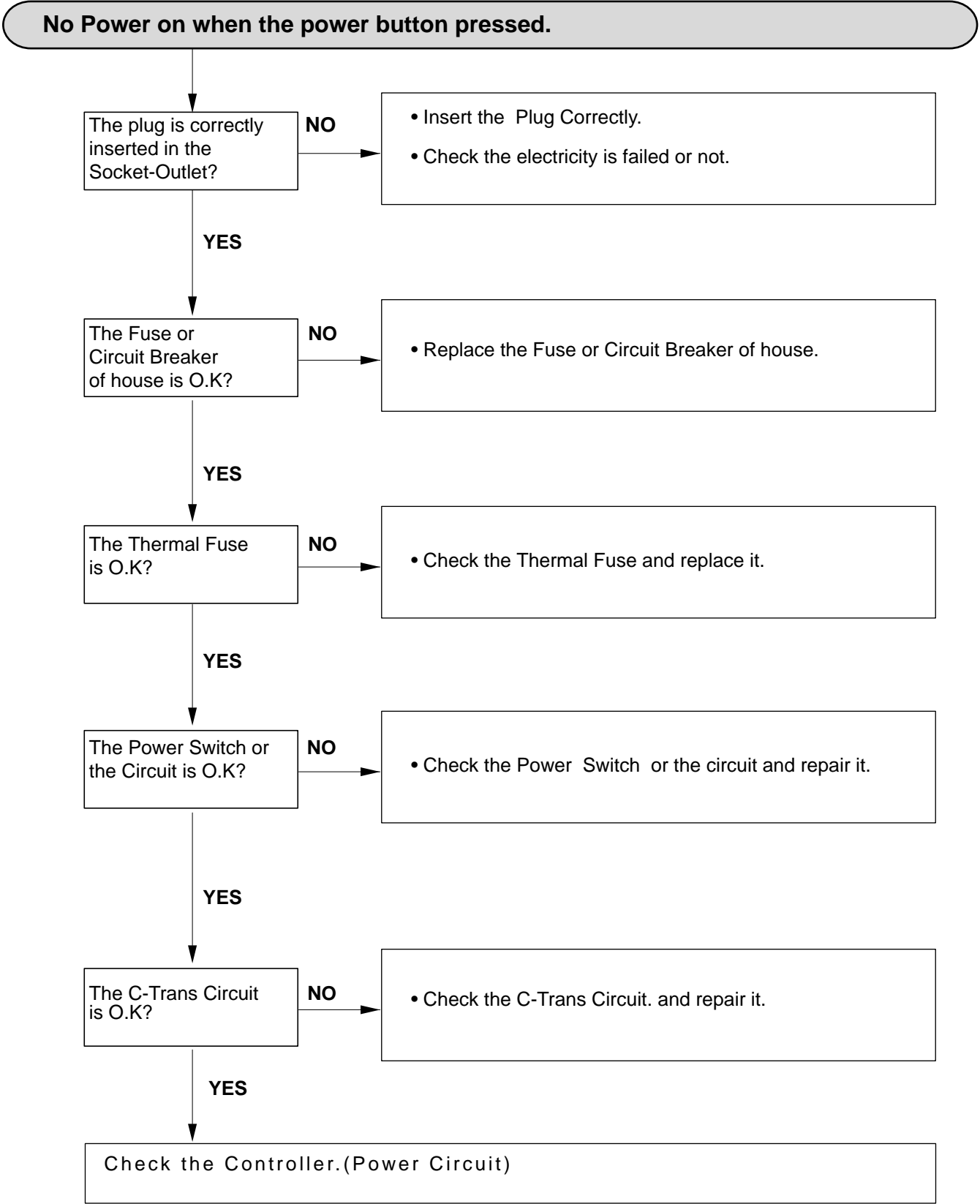

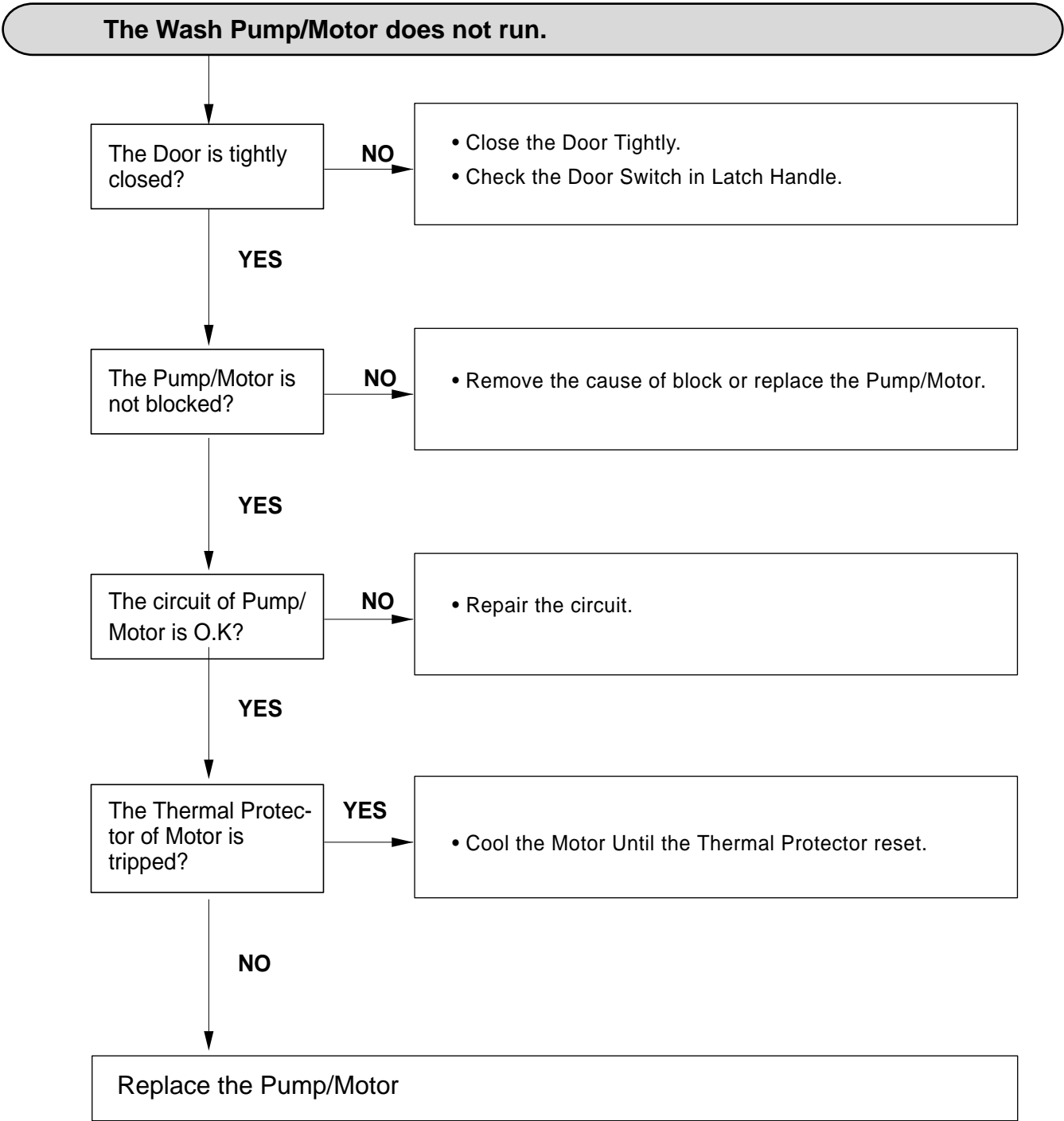

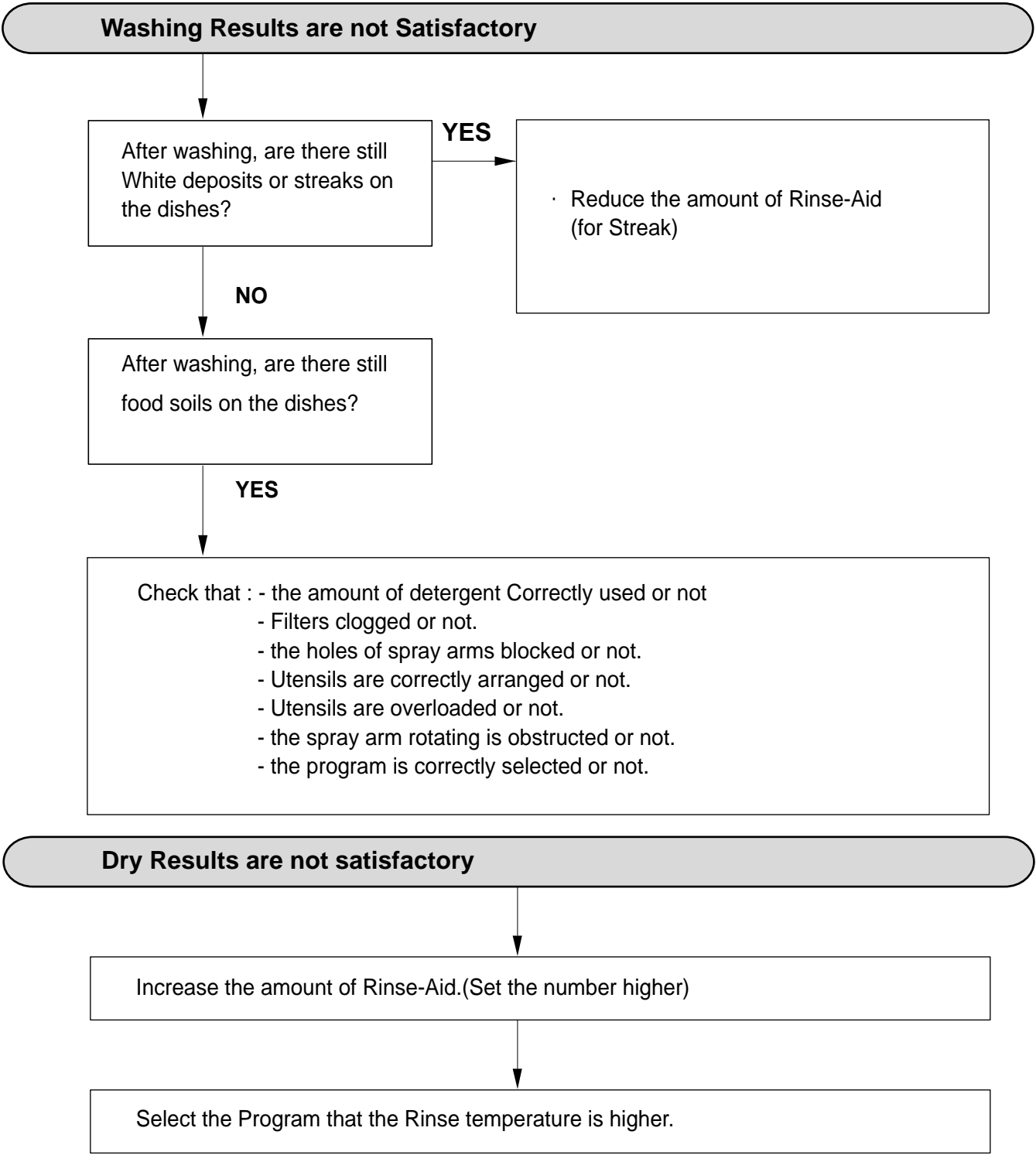

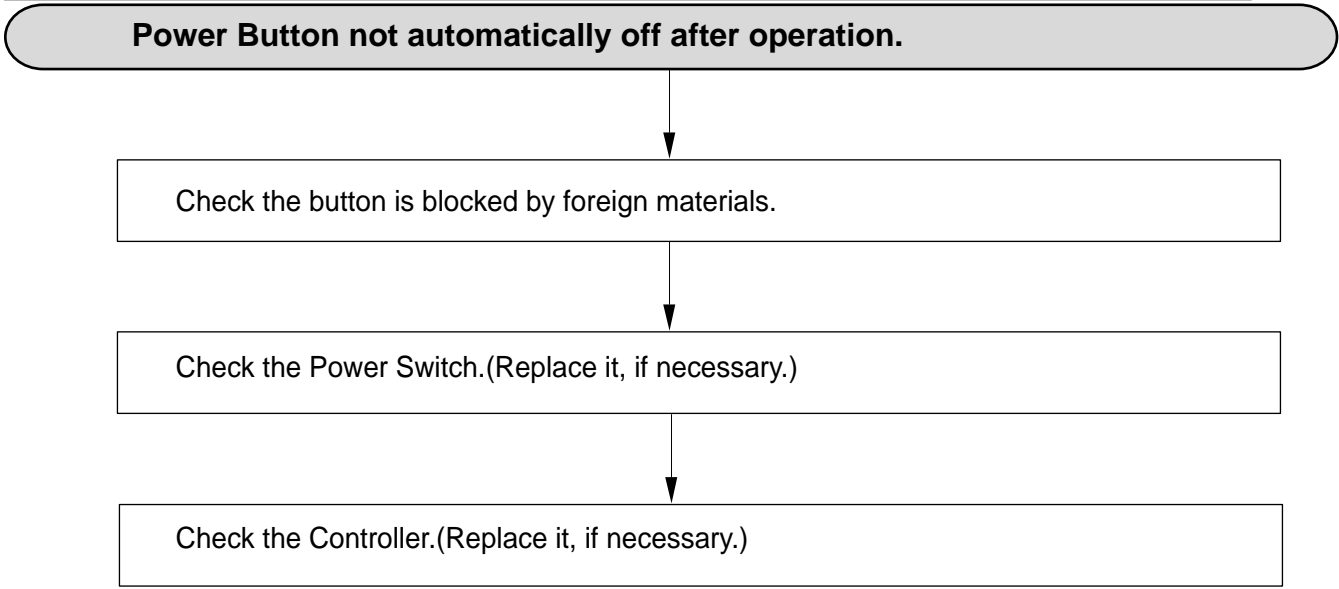

9. INSTALLATION INSTRUCTION

Step1: Prepare Cupboard opening

- 1. This dishwasher is designed to fit to the size shown as below.
- 2. Select a location as close to sink as possible for easy connections to water and drain lines.
- 3. The dishwasher should not be installed more than 3 meters from sink for proper drainage.
- 4. If dishwasher is to be installed in corner, minimum 5 cm of space is required between the washer and an adjacent cabinet or a wall.

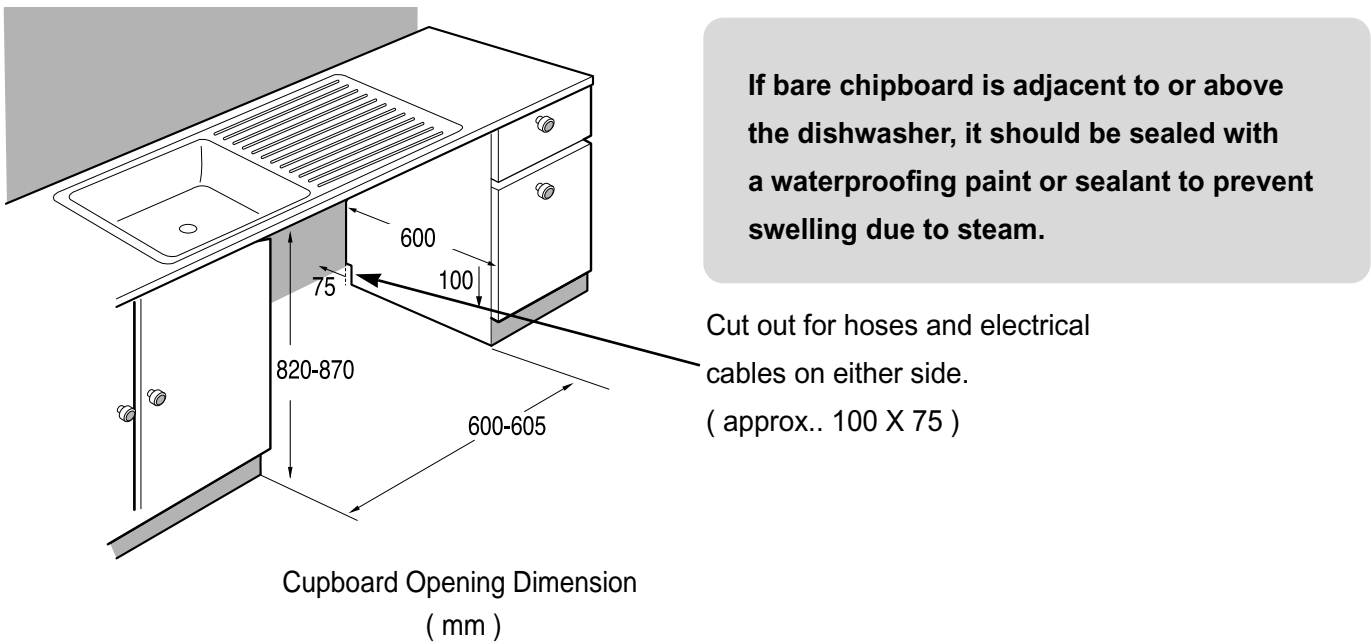

- Ensure the floor under the dishwasher is at the same level as the rest of the room to allow for any service requirements.

Step 2 : PREPARE ELECTRICAL WIRING

CAUTION

For personal safety, remove house fuse or open circuit breaker before installation.
Do not use an extension cord or adapter plug with this appliance.
Electrical and grounding connections must comply with the national electrical code/provincial and municipal code and/or other local codes.

- 1. This appliance must be supplied with correct rating voltage and hertz as shown on instruction manual, and connected to an individual, properly grounded branch circuit, protected by minimum 15 amp circuit breaker or time delay fuse.
Wiring must be 2 wires with ground.
- 2. The power point must be in a accessible location adjacent to and not behind the dishwasher and within 1.2 meters of the dishwasher side. A correctly rated, wired and earthed extension cord may be used if necessary.
(See Fig. A)
- 3. The power point must be correctly earthed, if in doubt, have it checked by a qualified Electrician. No other appliance shall be connected to the same plug outlet by a double adapter or similar plug.

Step 3 : PREPARE DISHWASHER FOR INSTALLATION

- 1. Lay the dishwasher on its back.
- 2. Adjust the legs to the needed height of cabinet as shown at below.

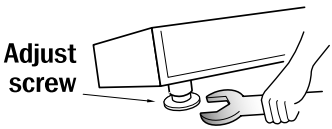

Step 4 : INSTALL THE DISHWASHER IN CUPBOARD

- 1. Before sliding the dishwasher into the cupboard opening, all necessary final height adjustment and balancing adjustment should be done using the spanner.
- 2. Slide the dishwasher into the cabinet opening carefully. Make sure that the drain hose inside the cabinet should not be kinked or exceeded.

CAUTION
If the height of cupboard is below 850mm, you should remove the top table by unscrewing the 2 screws. (Two of rear)

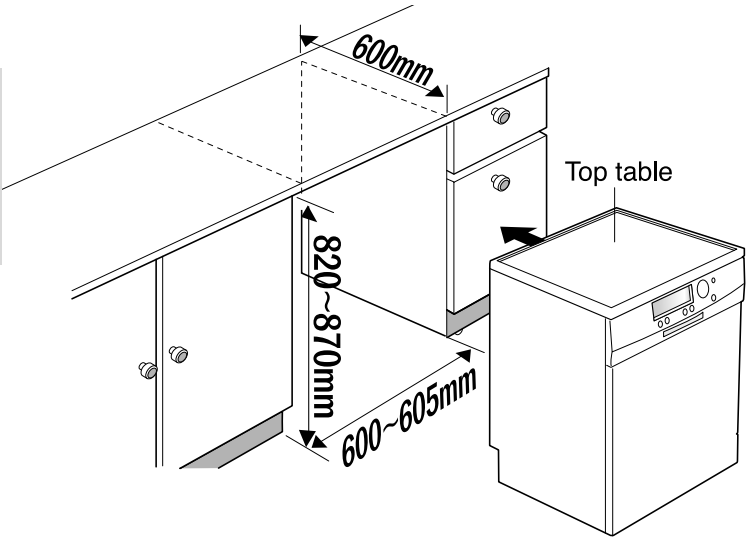

Step 5 : DRAIN LINE CONNECTION

1. If the end drain hose does not fit to the drain line, use a piece of rubber connector (not supplied) that must be resistant to heat and detergent and may be obtained from a plumbing shop.

2. There are 2 typical connections as shown in Figure A, B

¥The recommended methods of drain hose connection must be adhered to within the areas of Water Board Authority. Several other options are commonly used outside this area and local council or plumbers should be able to advise of these.

¥The S trap spigot must be drilled out cleanly and free of obstruction to its maximum internal diameter, if used for drainage.

¥To prevent syphoning, one of the following instruction methods must be followed :

■ When the drainage hose is connected to a sink S trap or waste disposal unit, the hose must be looped up to the under side of the bench top and secured.

Fig. A

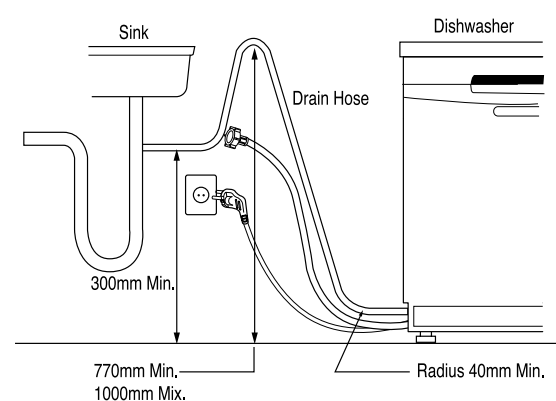

■ When the drain hose is connected to a separate stand pipe, it is essential that an air tight connection is made. Refer to Fig. B

Fig. B . Drainage connection-stand pipe

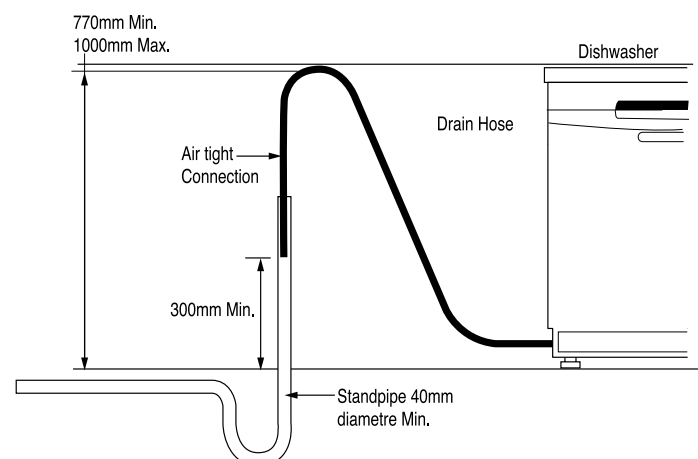

Drain Hose Extension

- Drain Hose extension kits are available from through your local service centre.

Extend drain Hose as shown below.

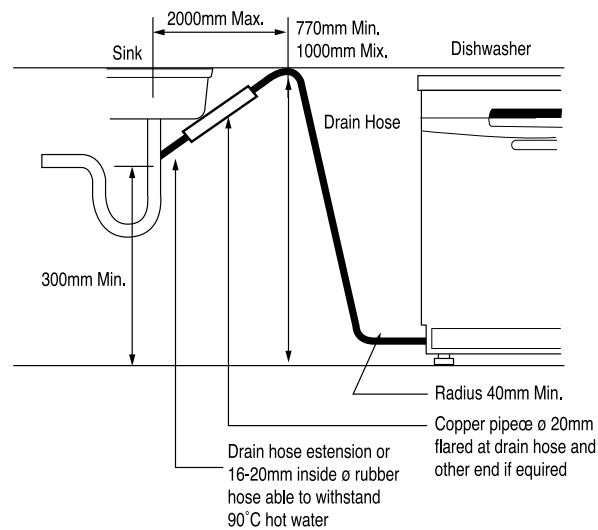

Step 6 : WATER SUPPLY CONNECTION

1. Connect the water supply hose to the valve behind dishwasher and the water tap as shown in figure.
This dishwasher may be fed with either hot or cold water. If the water can not be maintained below 65°C, the dishwasher must be connected to cold water.

2. When connecting, the sealing tape or sealing compound should be used to avoid water leaks.

Make sure that the line is not kinked or sharply bent.

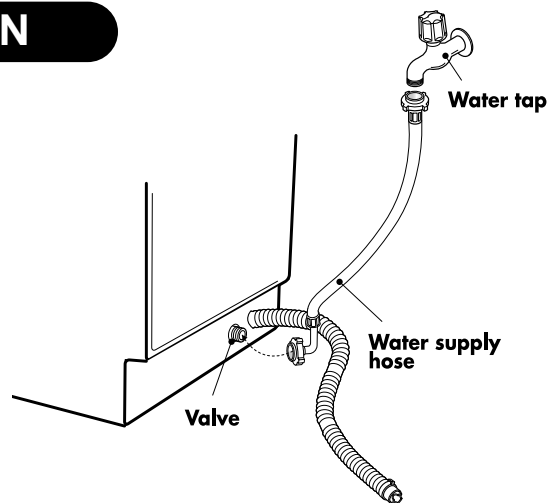

Step 7 : FINAL CHECK AND ASSEMBLING

1. Securely hand tighten supply hose to water supply.
Plug power cord into an earthed power point and switch on.
2. Operate the dishwasher through one cycle (Quick cycle is recommended) to check for water leak and operating conditions.

10. EXPLODED VIEW

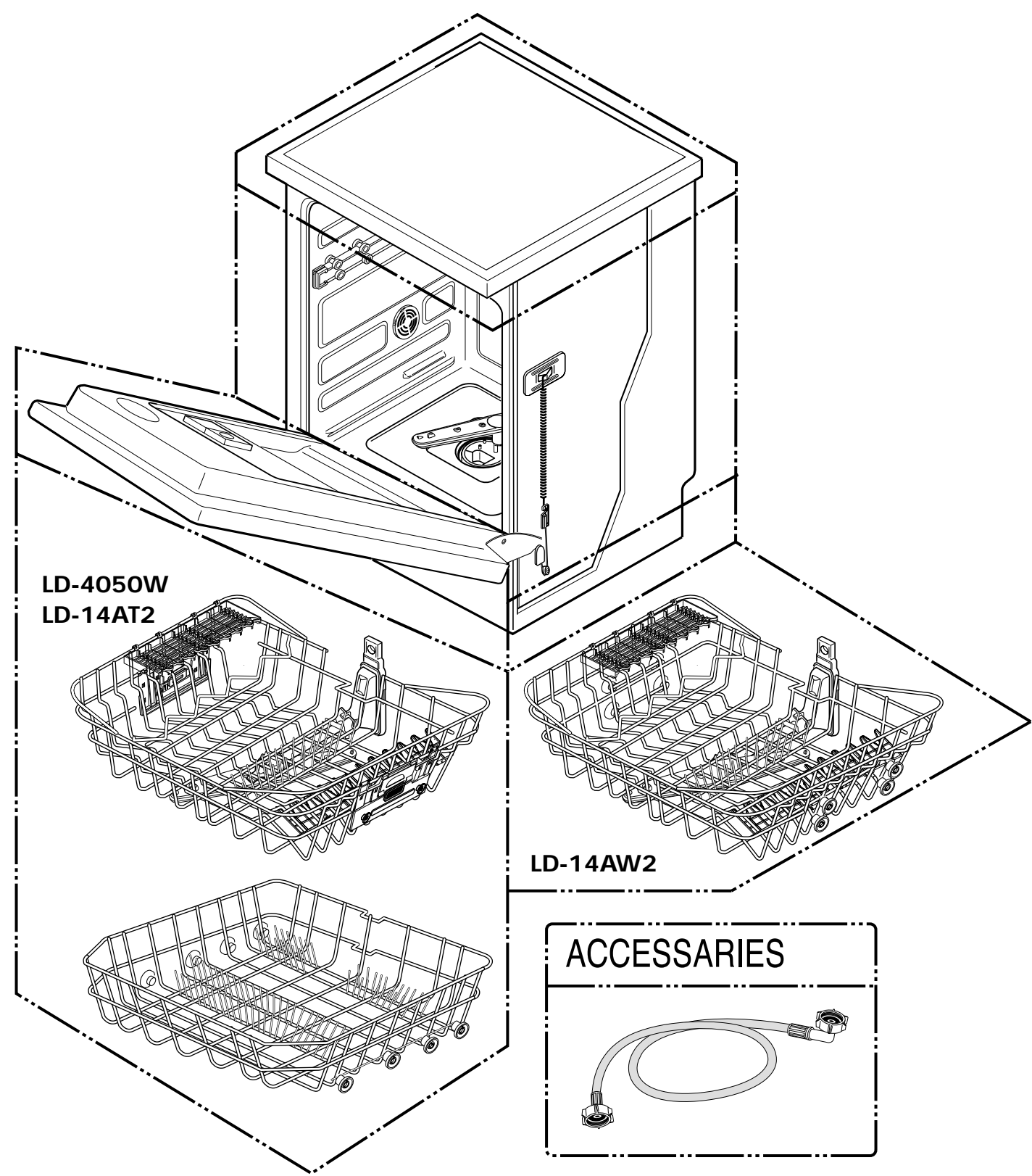

EXPLODED VIEW

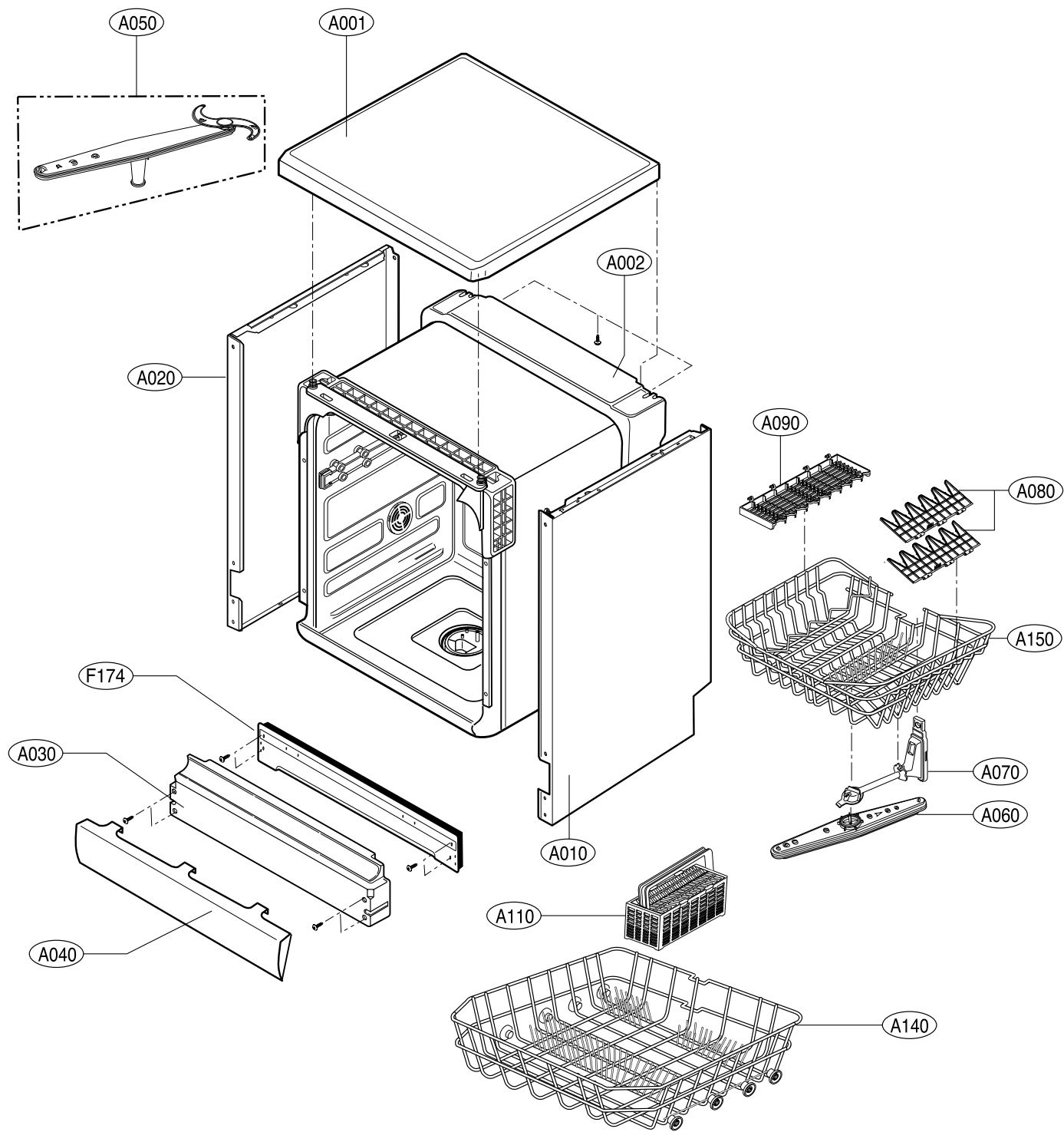

EXPLODED VIEW - TUB ASSEMBLY

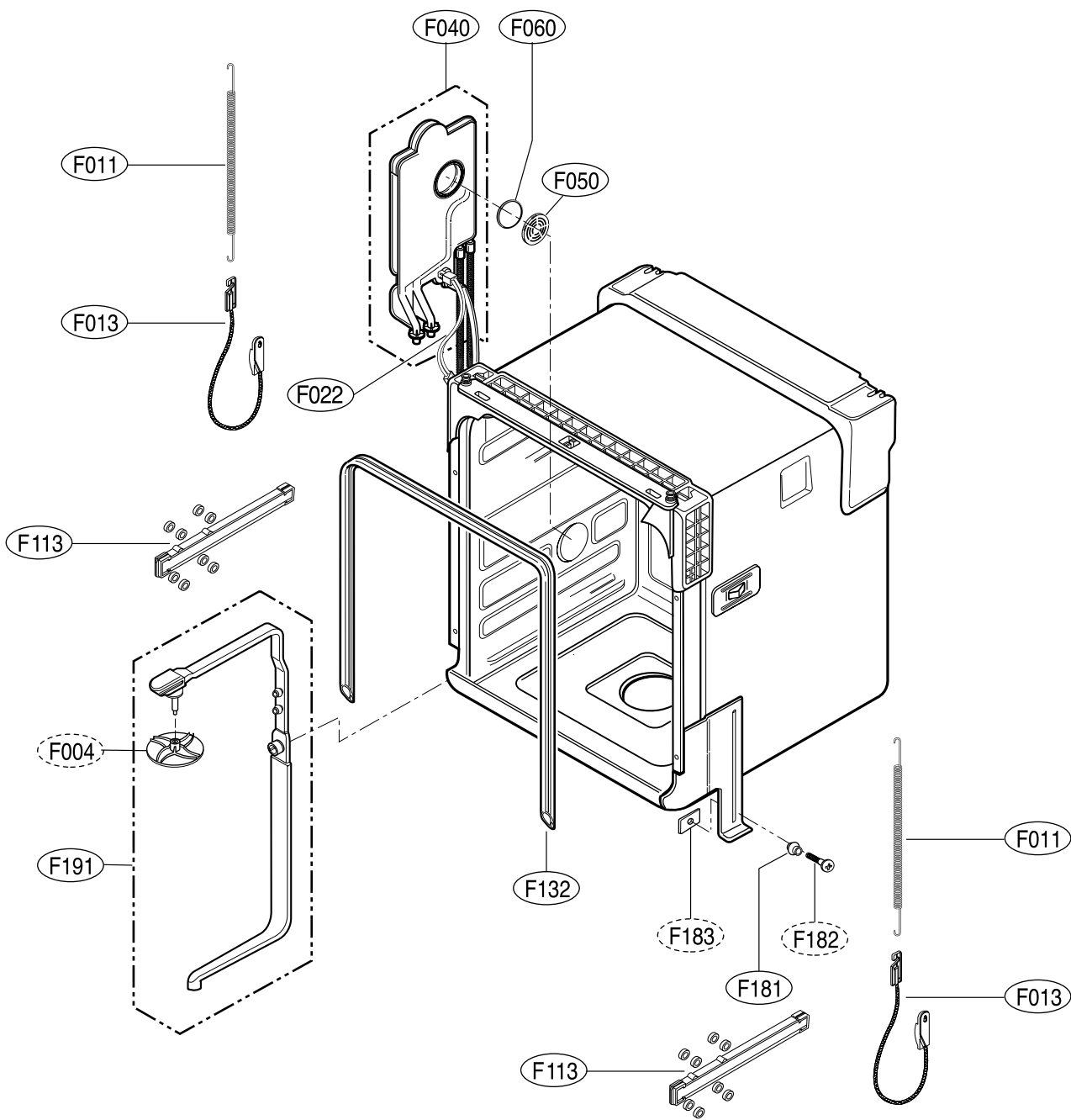

EXPLODED VIEW - SUMP ASSEMBLY

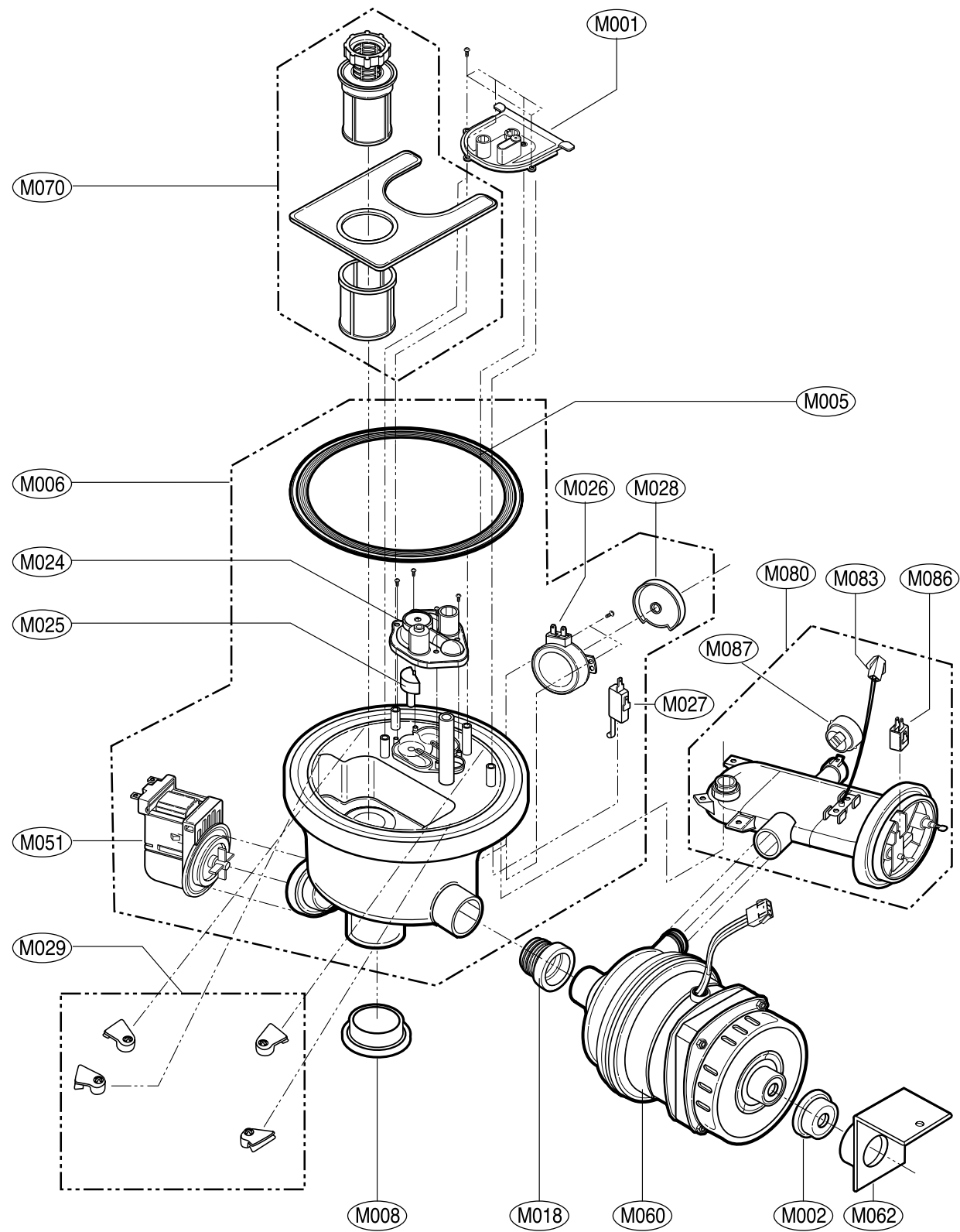

EXPLODED VIEW - BASE ASSEMBLY

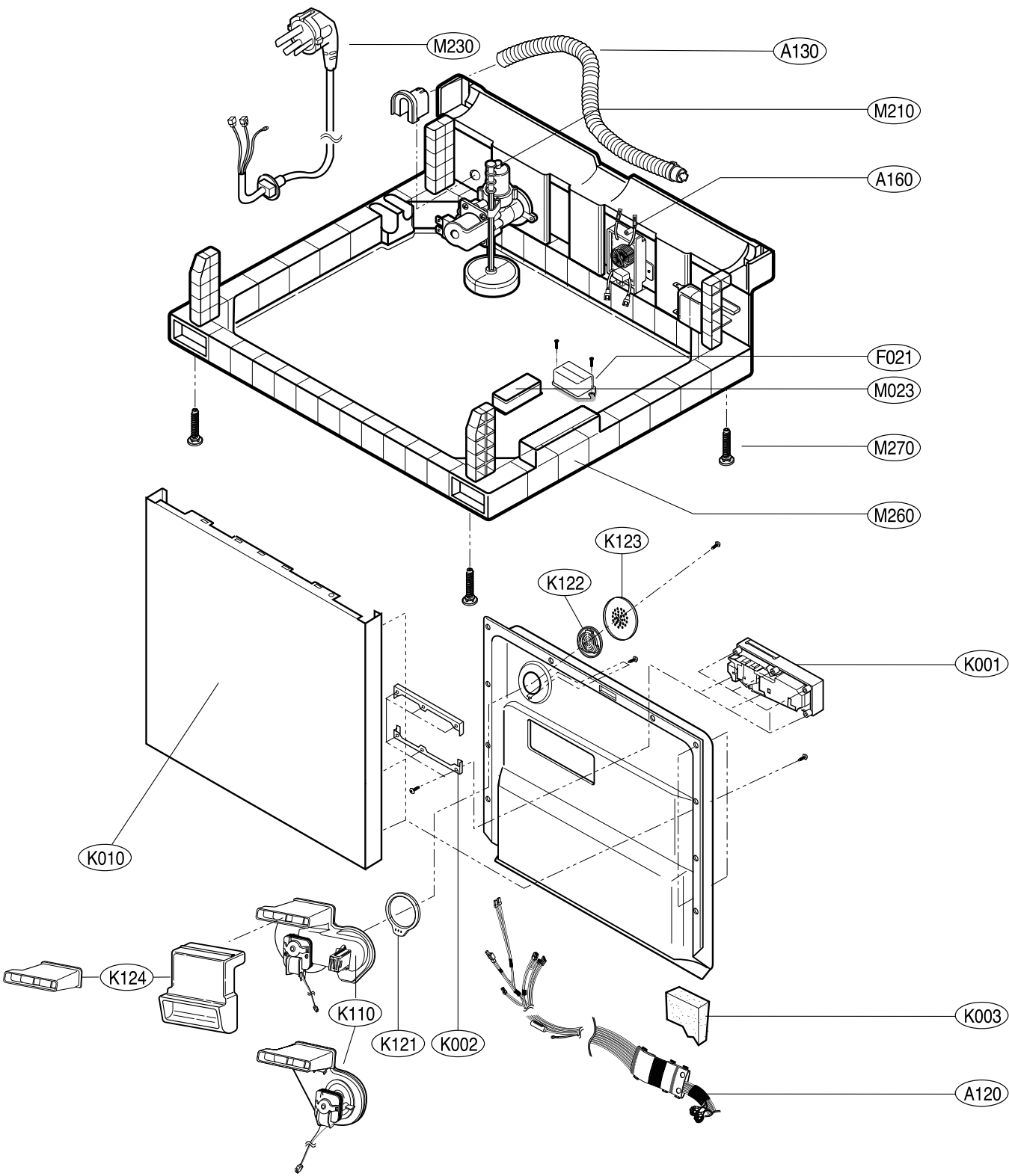

EXPLODED VIEW - DOOR ASSEMBLY

LD-4050W

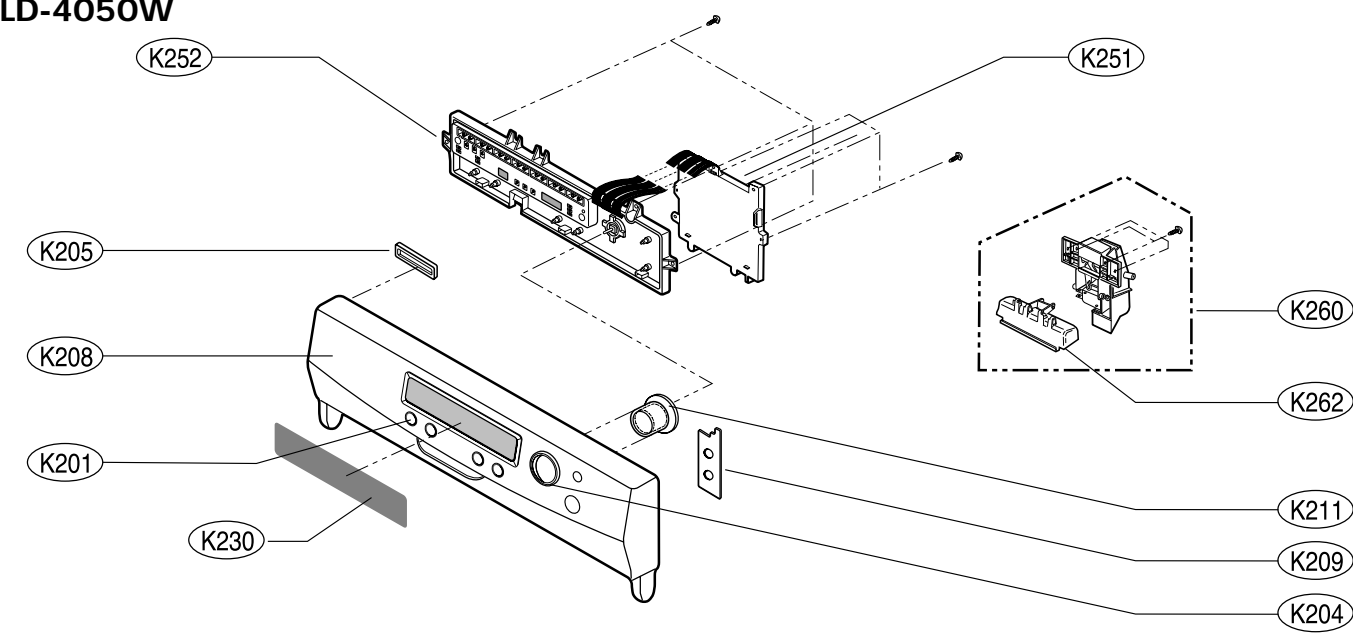

LD-14AT2
LD-14AW2

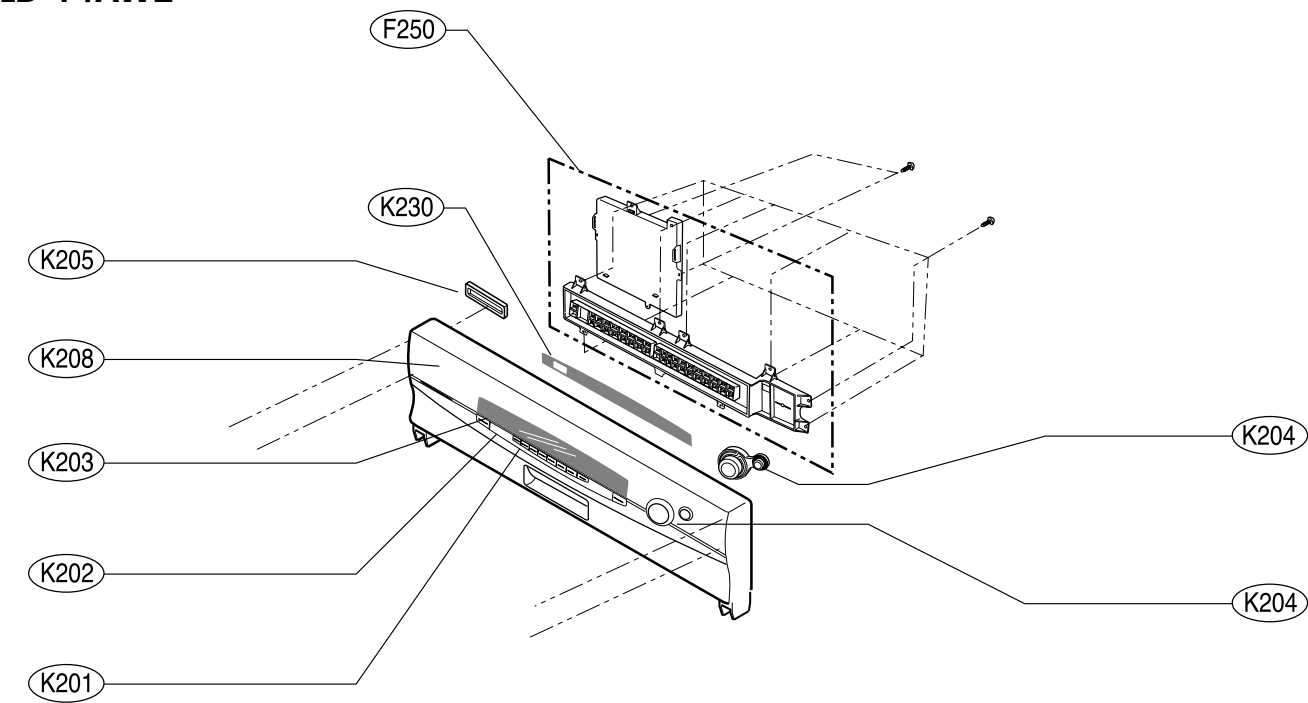

11. REPLACEMENT PART LIST

CAUTION : BEFORE REPLACING ANY OFTHESE COMPONENTS.
READ CAREFULLY THE SAFETY PRECAUTIONS IN THIS MANUAL

■NOTE : S(SAFETY PARTS), AL(ALTERNATIVE PARTS)

No.	PART NAME	PART No.	APPLIED MODEL	SPEC&COLOR	Q'ty
*001	MANUAL ASSEMBLY, OWNERS	3829ED3001Z 3829ED3003H 3929ED3003A	LD-4050W LD-14AT2 LD-14AW2		
*002	BOX, CARTON	3890EZ3314A 3890EZ3314A 3890EZ3314A	LD-4050W LD-14AT2 LD-14AW2		
*003	MANUAL, SERVICE	3828ED3001L		English	
A001	TOP PLATE ASSEMBLY	3301ER1001F 3301ER1001C	LD-4050W, LD-14AW2 LD-14AT2	WHITE WARM SILVER	1
A002	BLANCE WEIGHT	4866ED2003A			1
A010	CABINET	3112FD1079R 3112FD1079U	LD-4050W, LD-14AW2 LD-14AT2	WHITE PURPLE GRAY	1
A020	CABINET	3112FD1025R 3112FD1025U	LD-4050W, LD-14AW2 LD-14AT2	WHITE PURPLE GRAY	1
A030	BASE, CABINET	3040ED1001A			1
A040	COVER, LOWER	3550ED1001A 3550ED1001C	LD-4050W, LD-14AW2 LD-14AT2	WHITE PURPLE SILVER	1
A050	NOZZLE ASSEMBLY(LOWER)	5249FD1168C		STAINLESS	1
A060	NOZZLE ASSEMBLY(UPPER)	5249ED1003A		DARK GRAY	1
A070	GUIDE ASSEMBLY(UPPER)	4975ED2003A		DARK GRAY	1
A080	RACK(CUP RACK)	3750FD2036C		DARK GRAY	2
A090	RACK(KNIFE RACK)	3750ED2002C		DARK GRAY	1
A110	BASKET ASSEMBLY, SPOON	5005ED2003B		DARK GRAY	1
A120	HARNESS, PWB	6877ED1011B 6877ED1011D 6877ED1011C	LD-4050W LD-14AT2 LD-14AW2		1
A130	HOSE ASSEMBLY, DRAIN	5215ED3001B			1
A140	RACK ASSEMBLY(LOWER)	3751ED1001J 3751ED1001H	LD-4050W, LD-14AT2 LD-14AW2	DARK GRAY DARK GRAY	1
A150	RACK ASSEMBLY(UPPER)	3751ED1002D 3751ED1002E	LD-4050W, LD-14AT2 LD-14AW2	DARK GRAY DARK GRAY	1

No.	PART NAME	PART No.	APPLIED MODEL	SPEC&COLOR	Q'ty
A155	GUIDE ASSEMBLY(RIGHT)	4975ED2002C	LD-4050W, LD-14AT2		1
A156	GUIDE ASSEMBLY(LEFT)	4975ED2002D	LD-4050W, LD-14AT2		1
A160	FILTER ASSEMBLY(CIRC)	6201EC1004F		NOISE FILTER	1
A276	HOSE ASSEMBLY, INLET	3W40102H			1
F011	SPRING, HINGE	4970ED4004C			2
F013	CONNECTOR ASSEMBLY(MECH)	4933ED3002A		HINGE ROPE	2
F021	RELAY	6921ED3001A	LD-14AT2, LD-14AW2		1
F022	SENSOR ASSEMBLY	6501ED4001B			
F040	GUIDE ASSEMBLY	4975ED1003C		AIR GUIDE	1
F050	NUT, DRAWING	4020ED3641C		AIR GUIDE NUT	1
F060	GASKET	4986FD3643A		AIR GUIDE GASKET	1
F113	ROLLER	4580FD3087C			8
F132	TUB GASKET	3920FD3079C			1
F174	BRACKET ASSEMBLY	4811FD3667A			1
F181	ROLLER	4580ED3001A		HINGE ROLLER	2
F191	GUIDE ASSEMBLY	4975ED1002A		WATER GUIDE	1
K001	DISPENSER	4924FD2123D	LD-4050W	DARK GRAY	1
		4924FD2123C	LD-14AT2, LD-14AW2	DARK GRAY	
K002	BRACKET ASSEMBLY	4810FD3805A			2
K003	PACKING	3940FD4149A			2
K010	COVER, FRONT	3122FD1049K	LD-4050W, LD-14AW2	WHITE	1
		3122FD1049N	LD-14AT2	STAINLESS	
K110	BLOWER ASSEMBLY	5835ED2001B	LD-4050W	AIR MIXING	1
		5835ED2001A	LD-14AT2	AIR MIXING	
		5835FD2111C	LD-14AW2		
K121	BLOWER, IMPELLER(GASKET)	5834FD3095A		RUBBER, BLACK	1
K122	BLOWER, IMPELLER(PLASTIC)	5834FD3101A		INNER COVER	1
K123	BLOWER, IMPELLER(STAINLESS)	5834FD3100A		OUT COVER	1
K124	CONNECTOR(MECH), BLOWER	4932ED3002B	LD-4050W		1
		4932ED3001B	LD-14AT2		
K201	BUTTON, CONTROL	5020ED3002A	LD-4050W	WHITE	1
		5020ED1001B	LD-14AT2	WARM SILVER	
		5020ED1001A	LD-14AW2	WHITE	
K202	DECO, PANEL	3806ED1001D	LD-14AT2	WARM SILVER	1

No.	PART NAME	PART No.	APPLIED MODEL	SPEC&COLOR	Q'ty
		3806ED1001C	LD-14AW2	WHITE	
K203	WINDOW	3790ED1001B 3790ED1001A	LD-14AT2 LD-14AW2		1
K204	DECO, KNOB	3806ED3002A 3806ED2001B	LD-4050W LD-14AT2, LD-14AW2	SILVER	1
K205	SPONGE	3940FD4174D 3940FD4174C	LD-4050W LD-14AT2, LD-14AW2		1
K208	PANEL, CONTROL	3720ED1002L 3720ED1001F 3720ED1001B	LD-4050W LD-14AT2 LD-14AW2	WHITE, ENGLISH WARM SILVER WHITE	1
K209	POWER SWITCH KNOB(BUTTON)	5020ED3003A 4940ED2002B 4940ED2002B	LD-4050W LD-14AT2 LD-14AW2	WHITE SILVER SILVER	1
K211	KNOB ASSEMBLY	4941ED3001A	LD-4050W	ROTARY KNOB	1
K230	PLATE, CONTROL	3300ED3004N 3300ED3001V 3300ED3001U	LD-4050W LD-14AT2 LD-14AW2	WHITE BLACK SILVER	1
K250	PEB(PCB) ASSEMBLY, MAIN	6871EC1095A	LD-14AT2, LD-14AW2		1
K251	PEB(PCB) ASSEMBLY, MAIN	6871EC1100B	LD-4050W		1
K252	PEB(PCB) ASSEMBLY, DISPLAY	6871EC2031A	LD-4050W		1
K260	LATCH ASSEMBLY	4027FD3621K 4027FD3621H 4027FD3621F	LD-4050W LD-14AT2 LD-14AW2	WHITE GRAY WHITE	1
K262	LATCH, HANDLE	4026ED3002A 4026ED3001B 4026ED3001A	LD-4050W LD-14AT2 LD-14AW2	WHITE GRAY WHITE	1
M001	HOLDER(NOZZLE HOLDER)	4930ED2003A		DARK GRAY	1
M002	DAMPER(W, PUMP)	4900ED4003A			1
M005	SUMP GASKET	4986ED3005A		SUMP	1
M006	SUMP ASSEMBLY	3485ED1001E			1
M008	DAMPER	4900ED3001A			1
M018	GASKET	4986ED3001A			1
M023	DAMPER	4900ED4002A			1
M024	COVER, GUIDE	3550ED3009A			1

M210	VALVE ASSEMBLY, INLET	5221ED1002A		1
M230	POWER CORD	6410FA3406X		1
M260	BASE, CABINET	3040ED1002A		1